

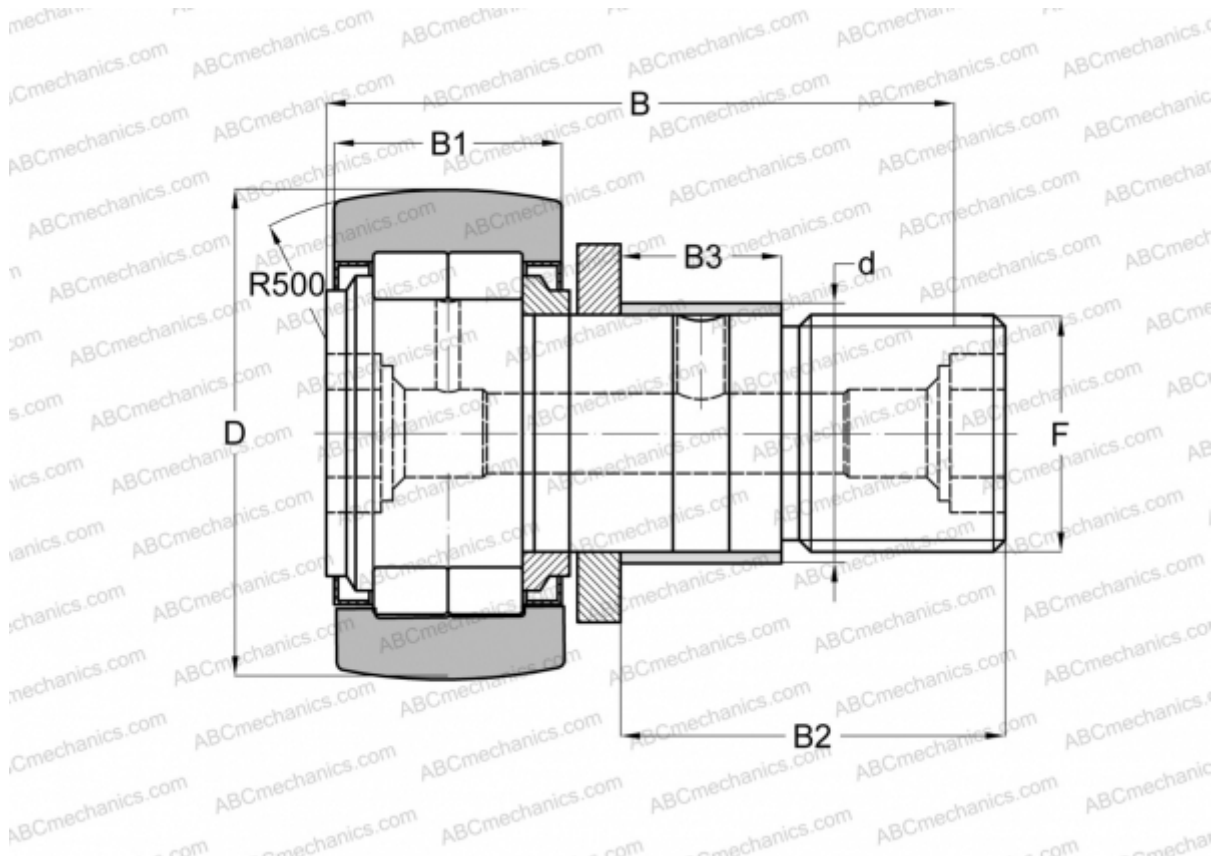

NUKRE 72 C FAG

Cam followers

TYPE: Roller bearings, Stud type track rollers, With axial guidance, full complement cylindrical roller set, with eccentric collar, labyrinth seals on both sides



Technical specification

DIMENSIONS, MM

d	28,000
D	72,000
B	80,000
B1	29,000
B2	49,500
B3	22,000
F	M24x1,5

WEIGHT, KG 1,039

MANUFACTURER [FAG](#)

INTERCHANGE

ABC	NUKRE 72
INA	NUKRE 72
SKF	NUKRE 72 A

