

## NUKRE 62 X SKF

Cam followers

TYPE: Roller bearings, Stud type track rollers, With axial guidance, full complement cylindrical roller set, with eccentric collar, labyrinth seals on both sides, cylindrical outer ring

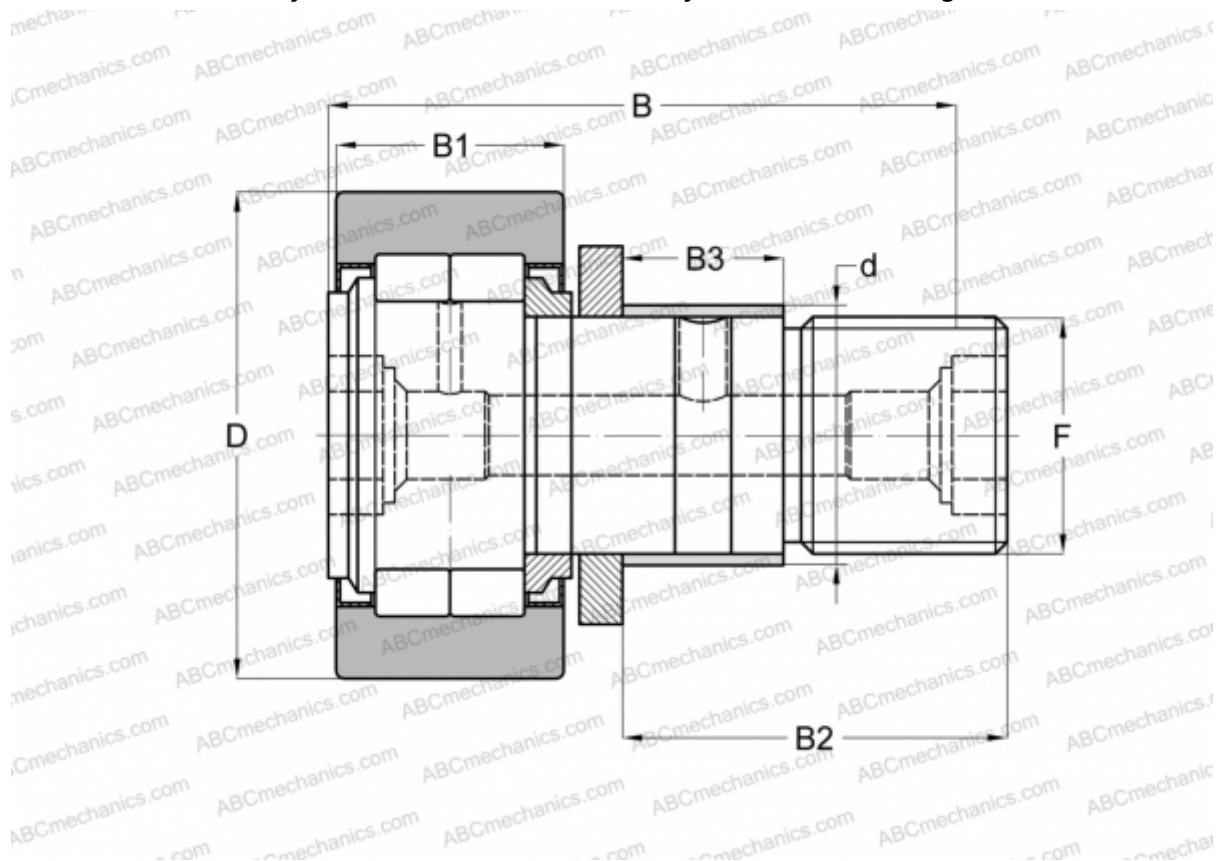

### Technical specification

#### DIMENSIONS, MM

d	28,000
D	62,000
B	80,000
B1	28,000
B2	49,500
F	M 24x1.5

**WEIGHT, KG** 0,824

**MANUFACTURER** [SKF](#)

#### INTERCHANGE

ABC	<a href="#">NUKRE 62 X</a>
FAG	<a href="#">NUKRE 62 C DZ</a>
INA	<a href="#">NUKRE 62 X</a>

#### CALCULATION DATA

Basic dynamic load rating, C	41,300 kN
Basic static load rating, Co	48,000 kN
Fatigue load limit, Pu	5,850 kN
Limiting speed	2600 r/min