

K 81217 SKF

Cylindrical roller thrust bearings

TYPE: Roller bearings, Thrust roller bearing, Cylindrical, Single direction, thrust cylindrical roller and cage assembly

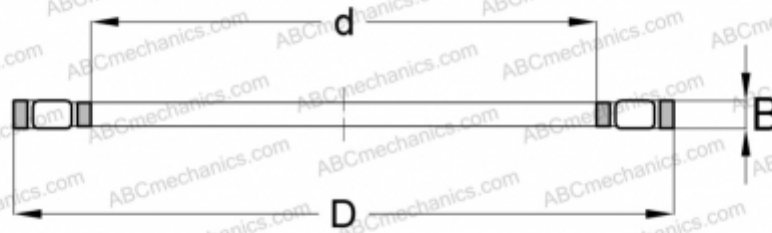

Technical specification

DIMENSIONS, MM

d	85,000
D	125,000
B	12,000

WEIGHT, KG 0,280

MANUFACTURER [SKF](#)

INTERCHANGE

ABC	K81217
INA	K81217-TV
IKO	AZK 8512512
FAG	K.81217 LPB