

CF 20 VUUR IKO

Cam followers

TYPE: Roller bearings, Stud type track rollers, With axial guidance, full complement bearing, sealing rings on both sides

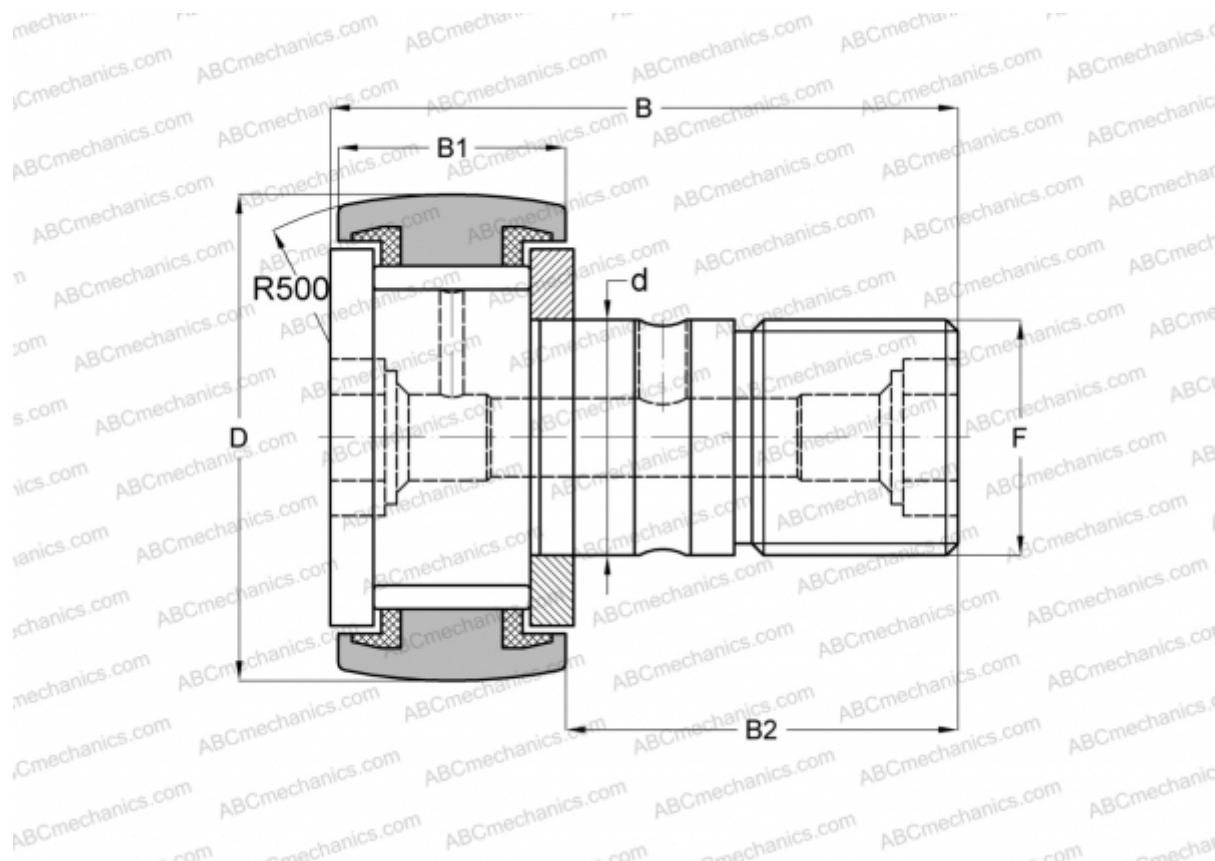

Technical specification

DIMENSIONS, MM

| | |
|----|---------|
| d | 20,000 |
| D | 52,000 |
| B | 66,100 |
| B1 | 24,000 |
| B2 | 40,500 |
| F | M20x1.5 |

WEIGHT, KG 0,465

MANUFACTURER [IKO](#)

INTERCHANGE

| | |
|--------|-----------------------------|
| ABC | KRV 52 PP |
| INA | KRV 52 PP A |
| SKF | KRV 52 PPA |
| McGill | MCF-52-S |

CALCULATION DATA

| | |
|------------------------------|-----------|
| Basic dynamic load rating, C | 33,200 kN |
| Basic static load rating, Co | 64,500 kN |