

## CF 24 VUUR IKO

Cam followers

TYPE: Roller bearings, Stud type track rollers, With axial guidance, full complement bearing, sealing rings on both sides

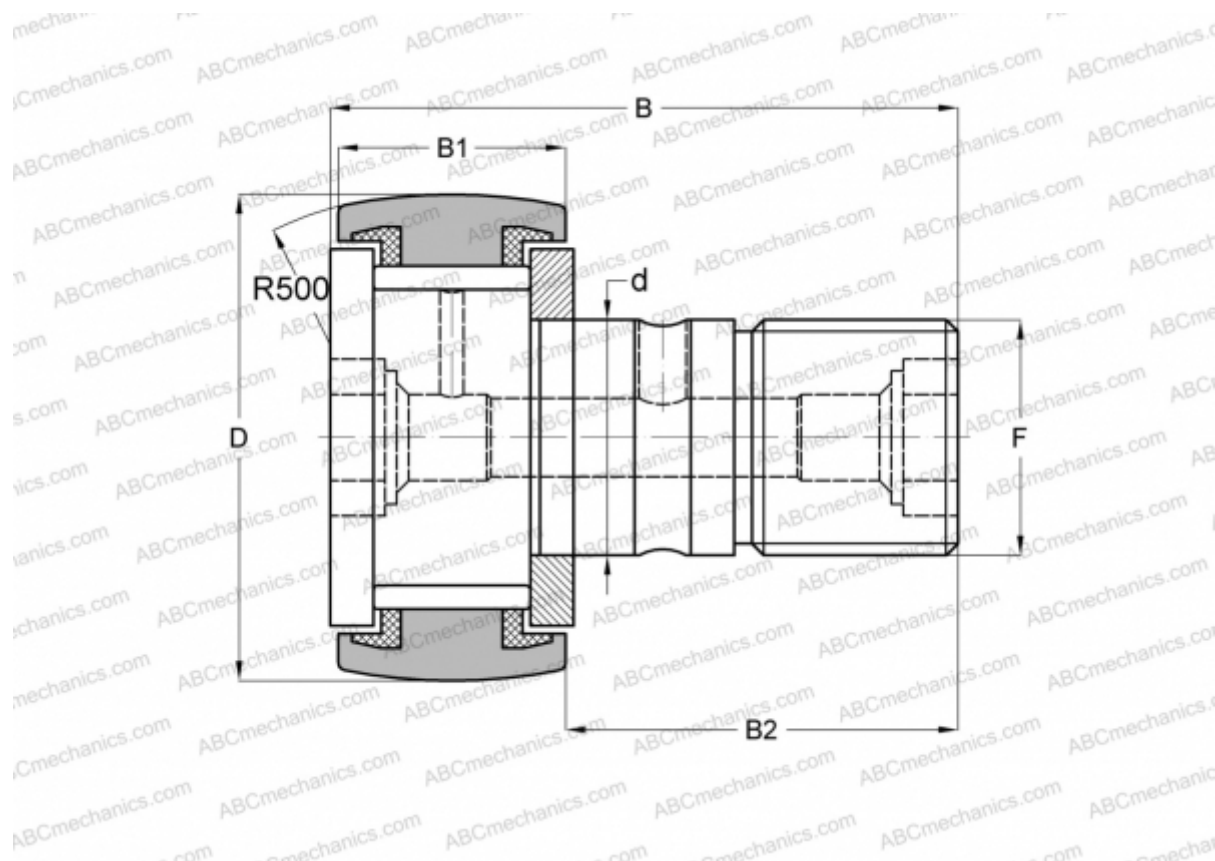

### Technical specification

#### DIMENSIONS, MM

d	24,000
D	62,000
B	80,100
B1	29,000
B2	49,500
F	M24x1.5

**WEIGHT, KG** 0,820

**MANUFACTURER** [IKO](#)

#### INTERCHANGE

ABC	<a href="#">KRV 62 PP</a>
INA	<a href="#">KRV 62 PP A</a>
SKF	<a href="#">KRV 62 PPA</a>
McGill	<a href="#">MCF-62-S</a>

#### CALCULATION DATA

Basic dynamic load rating, C	46,600 kN
Basic static load rating, Co	92,000 kN