

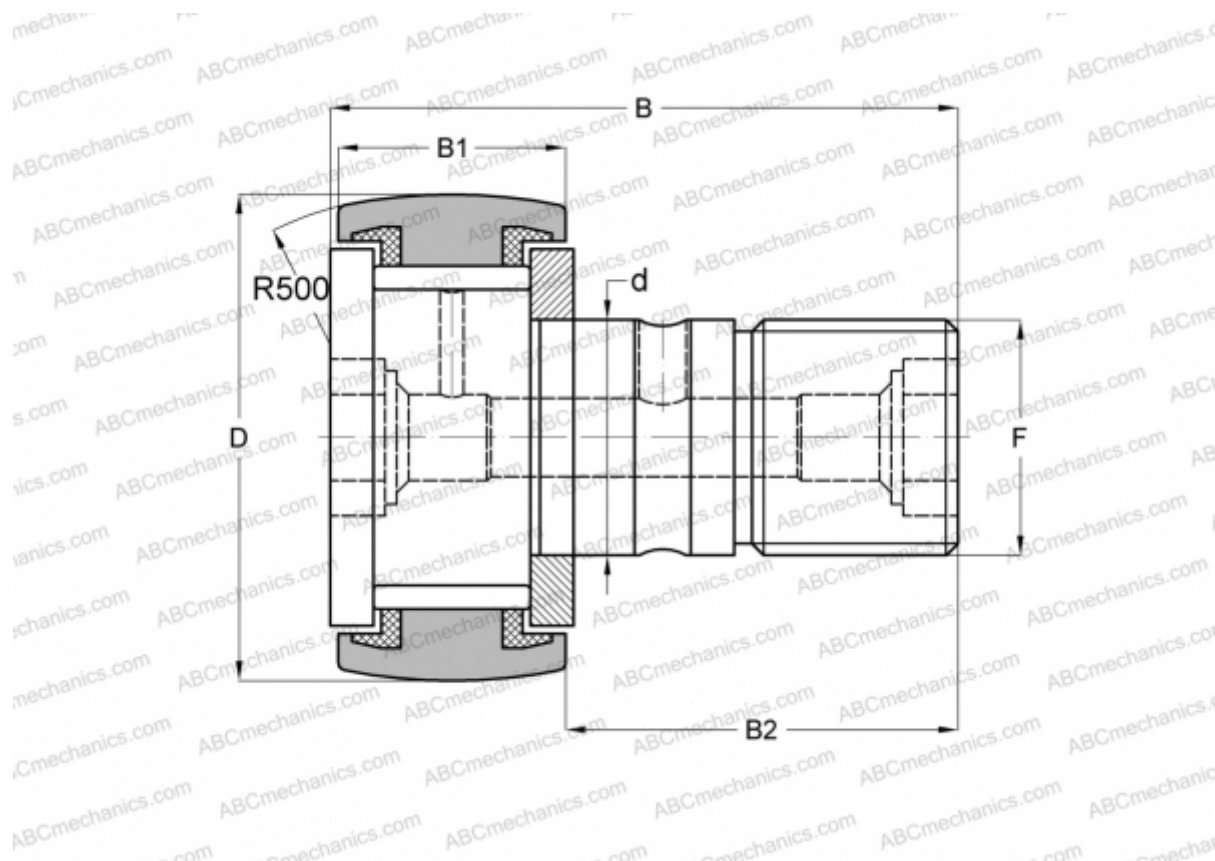

## MCF-80-S McGill

Cam followers

TYPE: Roller bearings, Stud type track rollers, With axial guidance, full complement bearing, sealing rings on both sides



### Technical specification

#### DIMENSIONS, MM

|    |         |
|----|---------|
| d  | 30,000  |
| D  | 80,000  |
| B  | 100,000 |
| B1 | 35,000  |
| B2 | 63,000  |
| F  | M30x1.5 |

**WEIGHT, KG** 1,665

**MANUFACTURER** [McGill](#)

#### INTERCHANGE

|     |                             |
|-----|-----------------------------|
| ABC | <a href="#">KRV 80 PP</a>   |
| INA | <a href="#">KRV 80 PP A</a> |
| SKF | <a href="#">KRV 80 PPA</a>  |
| IKO | <a href="#">CF 30 VUUR</a>  |

