

CFE 6 VUU IKO

Cam followers

TYPE: Roller bearings, Stud type track rollers, With axial guidance, eccentric stud, full complement bearing, gap seal on both side, gap seal on both side, cylindrical outer ring

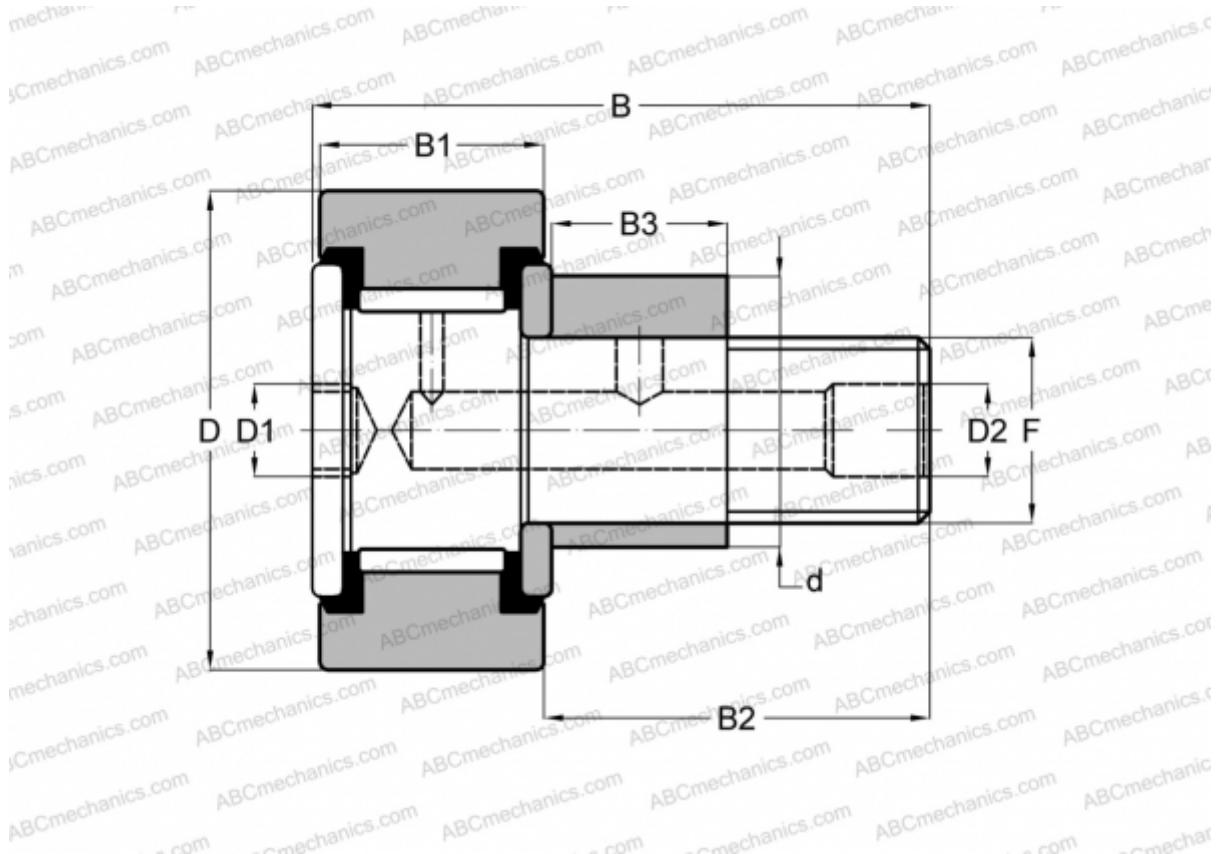

Technical specification

DIMENSIONS, MM

d	9,000
D	16,000
B	28,200
B1	11,000
B2	16,000
F	M6x1

WEIGHT, KG 0,021

MANUFACTURER [IKO](#)

INTERCHANGE

ABC	CFE 6 VUU
SKF	KRVE 16 PPX

CALCULATION DATA

Basic dynamic load rating, C	6,980 kN
------------------------------	----------

CALCULATION DATA

Basic static load rating, Co	8,500 kN
------------------------------	----------