

KRVE 19 PPX SKF

Cam followers

TYPE: Roller bearings, Stud type track rollers, With axial guidance, eccentric stud, full complement bearing, gap seal on both side, gap seal on both side, cylindrical outer ring

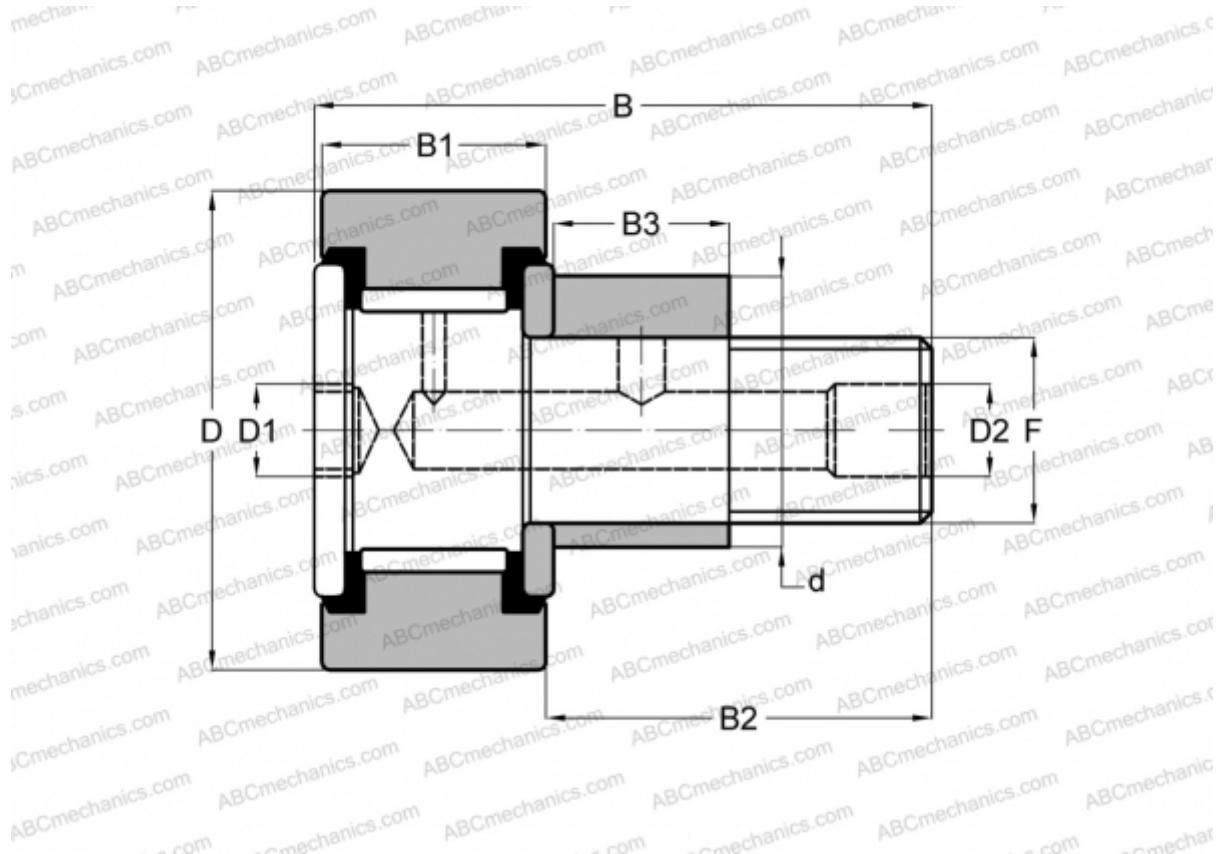

Technical specification

DIMENSIONS, MM

d	11,000
D	19,000
B	32,200
B1	11,000
B2	20,000
F	M8x1.25

MANUFACTURER [SKF](#)

INTERCHANGE

ABC	CFE 8 VUU
IKO	CFE 8 VUU