

CFE 10 VUUM IKO

Cam followers

TYPE: Roller bearings, Stud type track rollers, With axial guidance, eccentric stud, full complement bearing, gap seal on both side, gap seal on both side, cylindrical outer ring

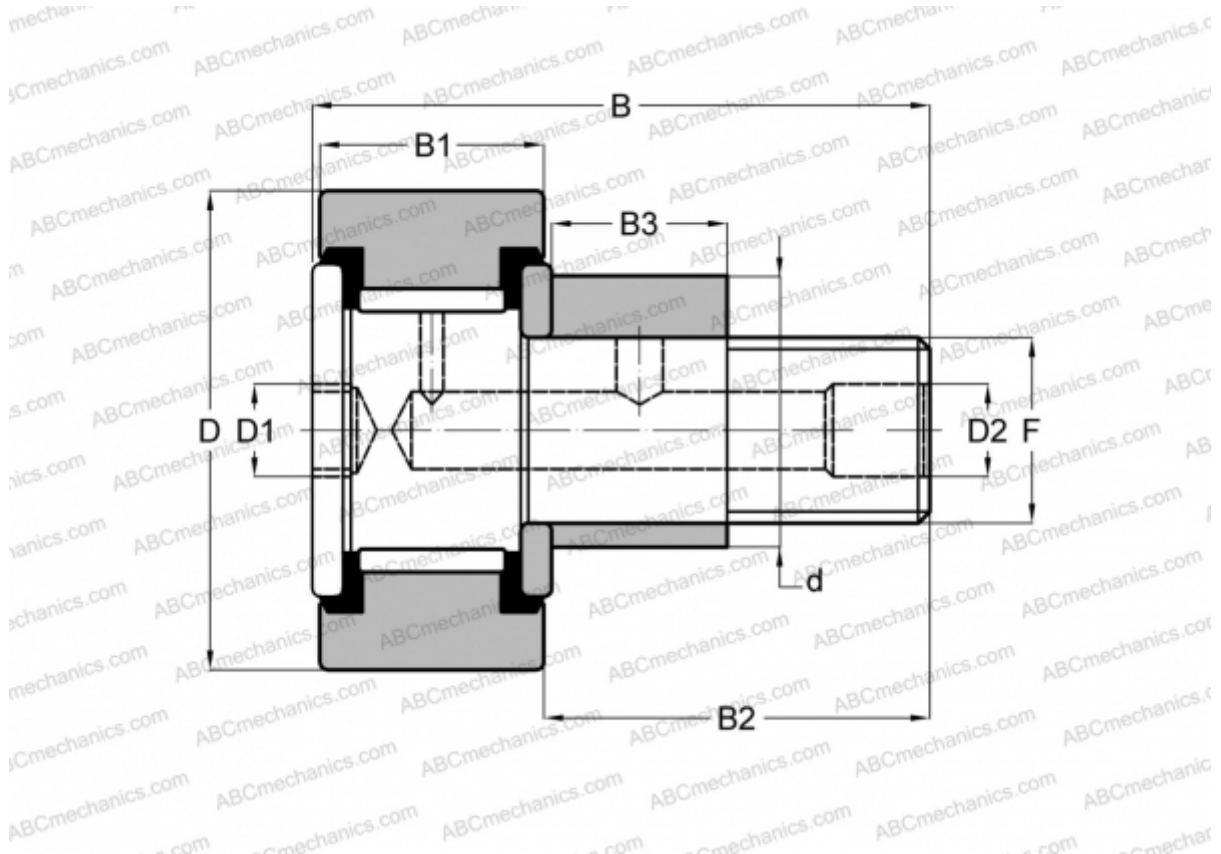

Technical specification

DIMENSIONS, MM

d	13,000
D	22,000
B	36,200
B1	12,000
B2	23,000
F	M10x1

MANUFACTURER

[IKO](#)

INTERCHANGE

ABC	CFE 10 VUUM
SKF	KRVE 22 PPX

CALCULATION DATA

Basic dynamic load rating, C	9,570 kN
Basic static load rating, Co	14,500 kN