

## CFE 8 VB IKO

Cam followers

TYPE: Roller bearings, Stud type track rollers, With axial guidance, eccentric stud, full complement bearing, gap seal on both side, cylindrical outer ring, hex socket

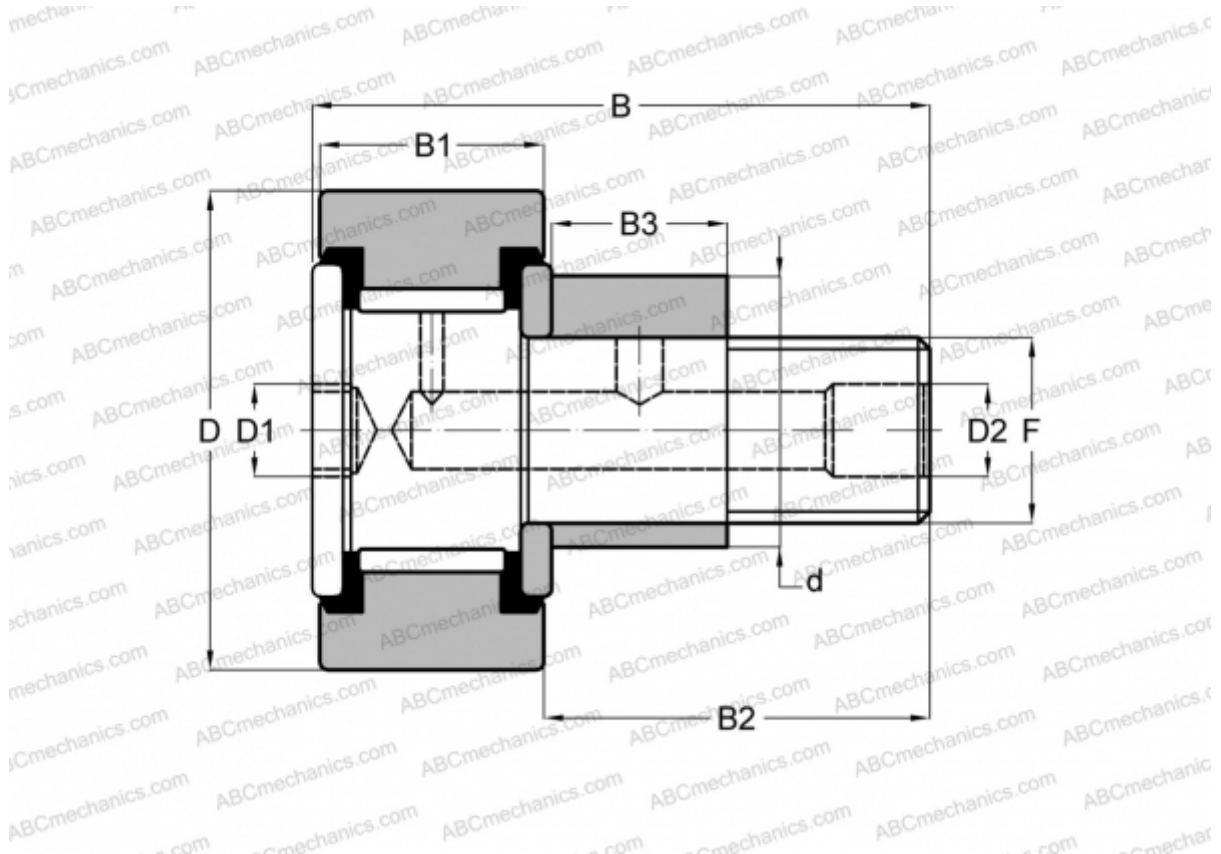

### Technical specification

#### DIMENSIONS, MM

d	11,000
D	19,000
B	32,200
B1	11,000
B2	20,000
F	M8x1.25

#### MANUFACTURER

[IKO](#)

#### INTERCHANGE

ABC	<a href="#">CFE 8 VB</a>
INA	<a href="#">KRVE 19 XSK</a>

#### CALCULATION DATA

Basic dynamic load rating, C	8,170 kN
Basic static load rating, Co	11,200 kN