

NUCF 10-1 R IKO

Cam followers

TYPE: Roller bearings, Stud type track rollers, With axial guidance, full complement cylindrical roller set, labyrinth seals on both sides

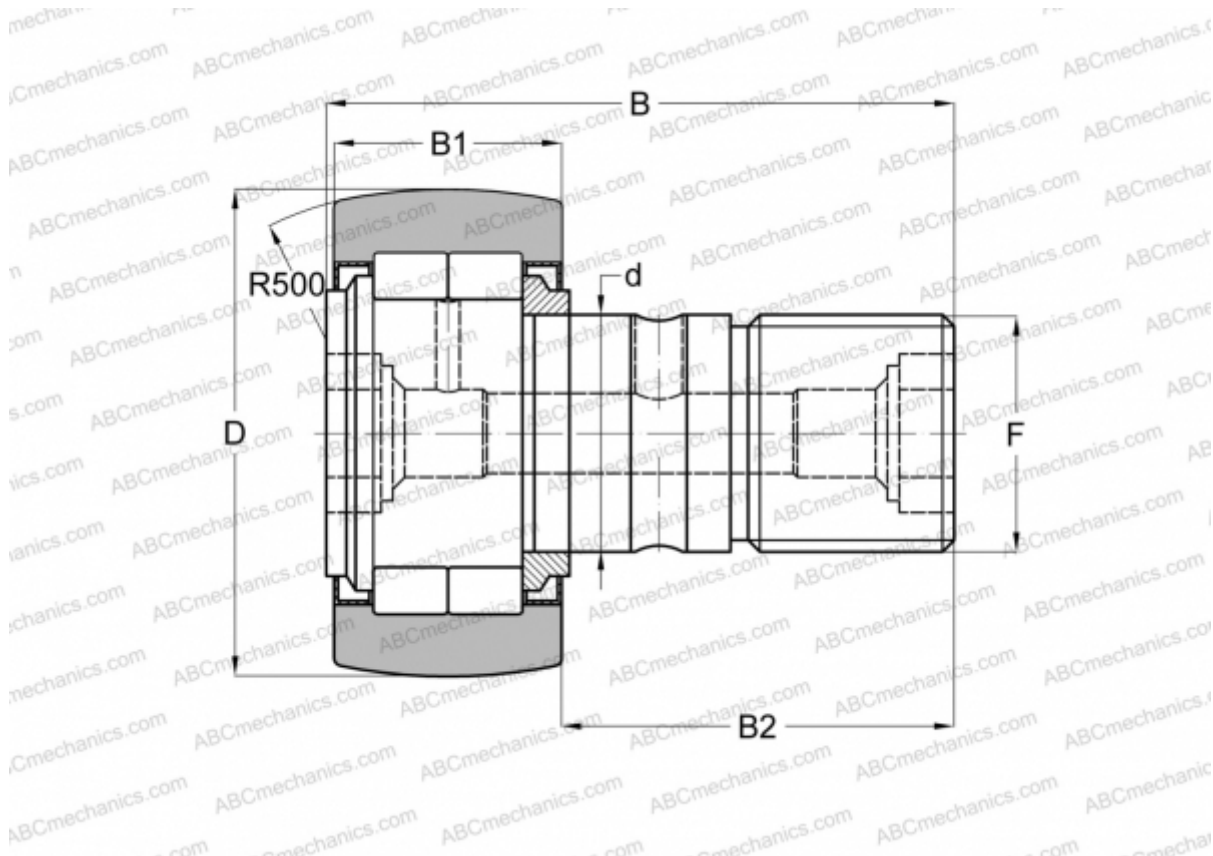

Technical specification

DIMENSIONS, MM

| | |
|----|----------|
| d | 10,000 |
| D | 26,000 |
| B | 36,200 |
| B1 | 12,000 |
| B2 | 23,000 |
| F | M10x1.25 |

WEIGHT, KG 0,058

MANUFACTURER [IKO](#)

INTERCHANGE

| | |
|-----|-----------------------------|
| ABC | NUCF 10-1 R |
|-----|-----------------------------|

CALCULATION DATA

| | |
|------------------------------|-----------|
| Basic dynamic load rating, C | 10,400 kN |
| Basic static load rating, Co | 11,500 kN |