

NUKR 52 A SKF

Cam followers

TYPE: Roller bearings, Stud type track rollers, With axial guidance, full complement cylindrical roller set, labyrinth seals on both sides

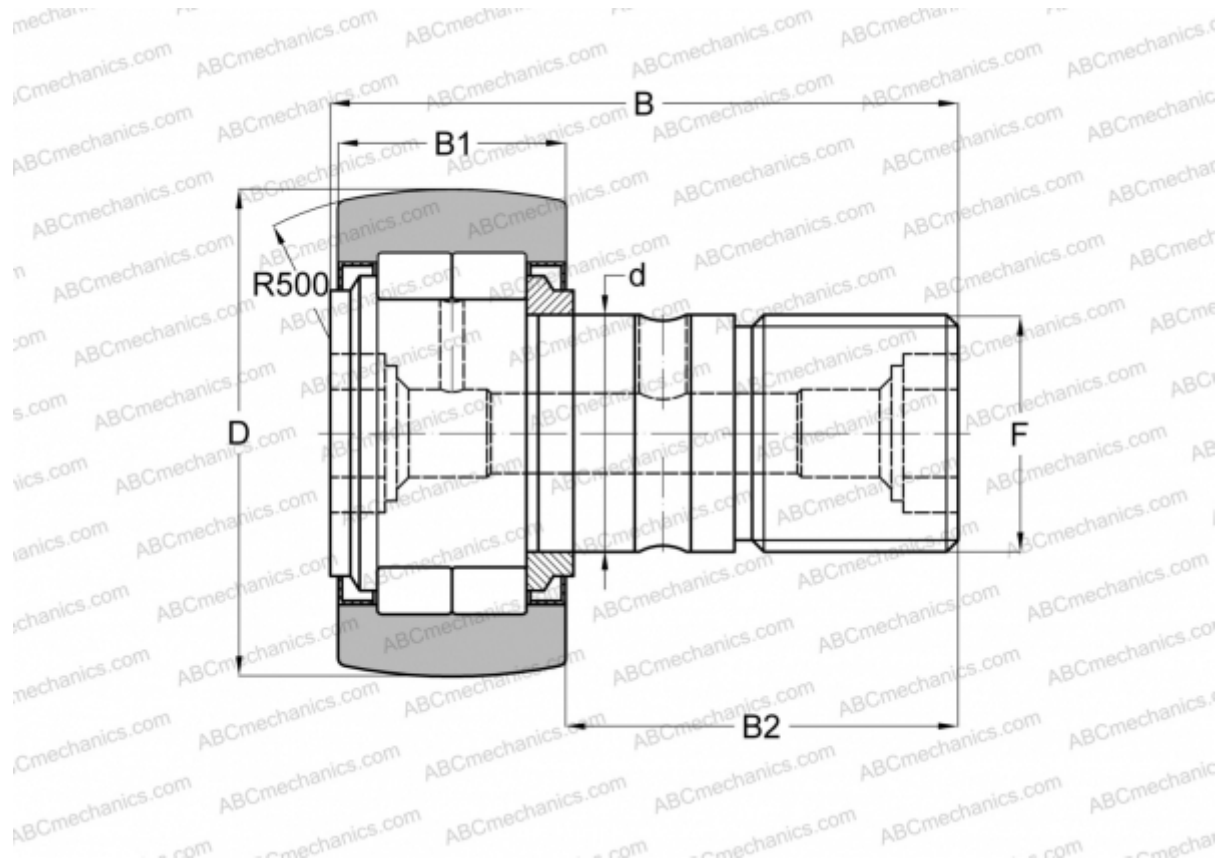

Technical specification

DIMENSIONS, MM

d	20,000
D	52,000
B	66,000
B1	24,000
B2	67,500
F	M 20x1.5

WEIGHT, KG 0,450

MANUFACTURER [SKF](#)

INTERCHANGE

ABC	NUKR 52
FAG	NUKR 52 C(NUKD 52)
INA	NUKR 52
IKO	NUCF 20 R

INTERCHANGE

McGill [MCFD 52 S](#)

CALCULATION DATA

Basic dynamic load rating, C	29,700 kN
Basic static load rating, Co	36,000 kN
Fatigue load limit, Pu	4,250 kN
Limiting speed	3200 r/min