

NUKR 62 A SKF

Cam followers

TYPE: Roller bearings, Stud type track rollers, With axial guidance, full complement cylindrical roller set, labyrinth seals on both sides

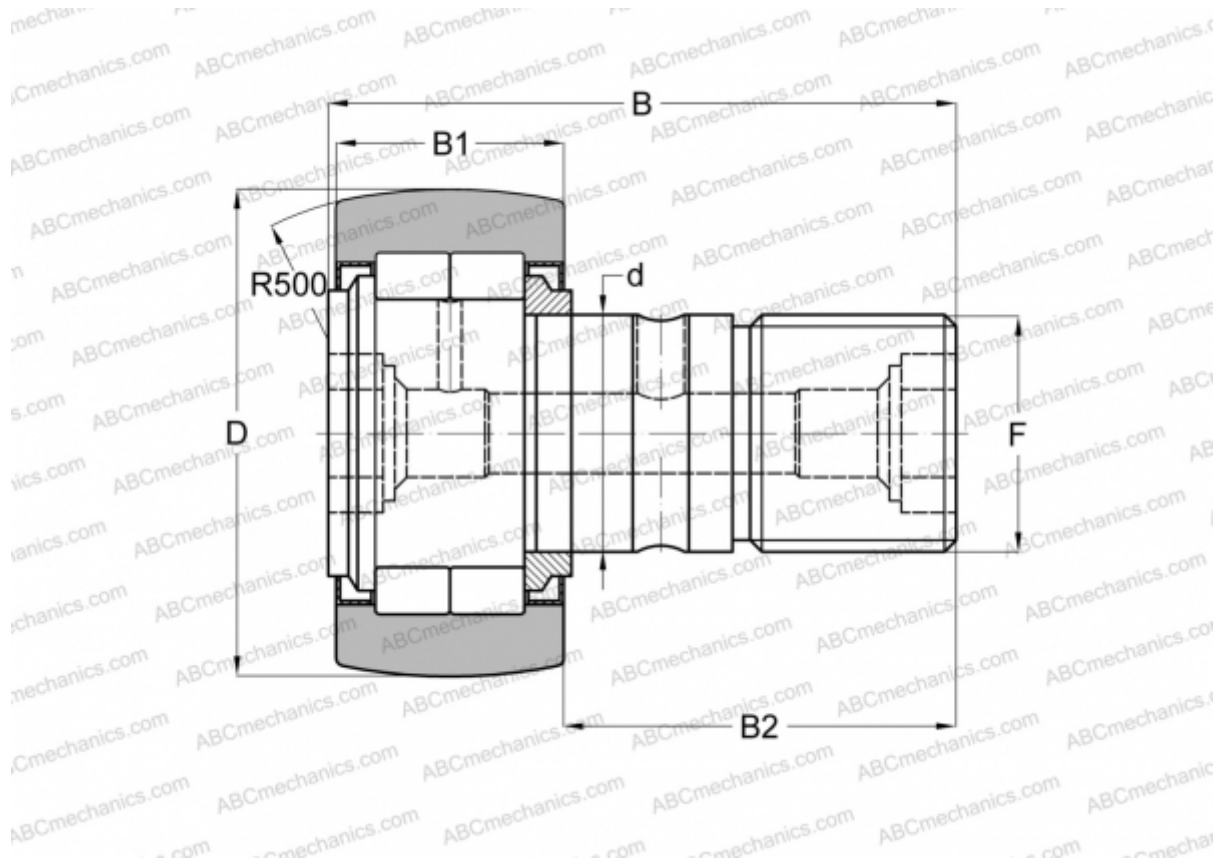

Technical specification

DIMENSIONS, MM

d	24,000
D	62,000
B	80,000
B1	28,000
B2	49,500
F	M 24x1.5

WEIGHT, KG 0,795

MANUFACTURER [SKF](#)

INTERCHANGE

ABC	NUKR 62
FAG	NUKR 62 C(NUKD 62)
INA	NUKR 62
IKO	NUCF 24 R

INTERCHANGE

McGill [MCFD 62 S](#)

CALCULATION DATA

Basic dynamic load rating, C	41,300 kN
Basic static load rating, Co	48,000 kN
Fatigue load limit, Pu	5,850 kN
Limiting speed	2600 r/min