

NUCF 24-1 R IKO

Cam followers

TYPE: Roller bearings, Stud type track rollers, With axial guidance, full complement cylindrical roller set, labyrinth seals on both sides

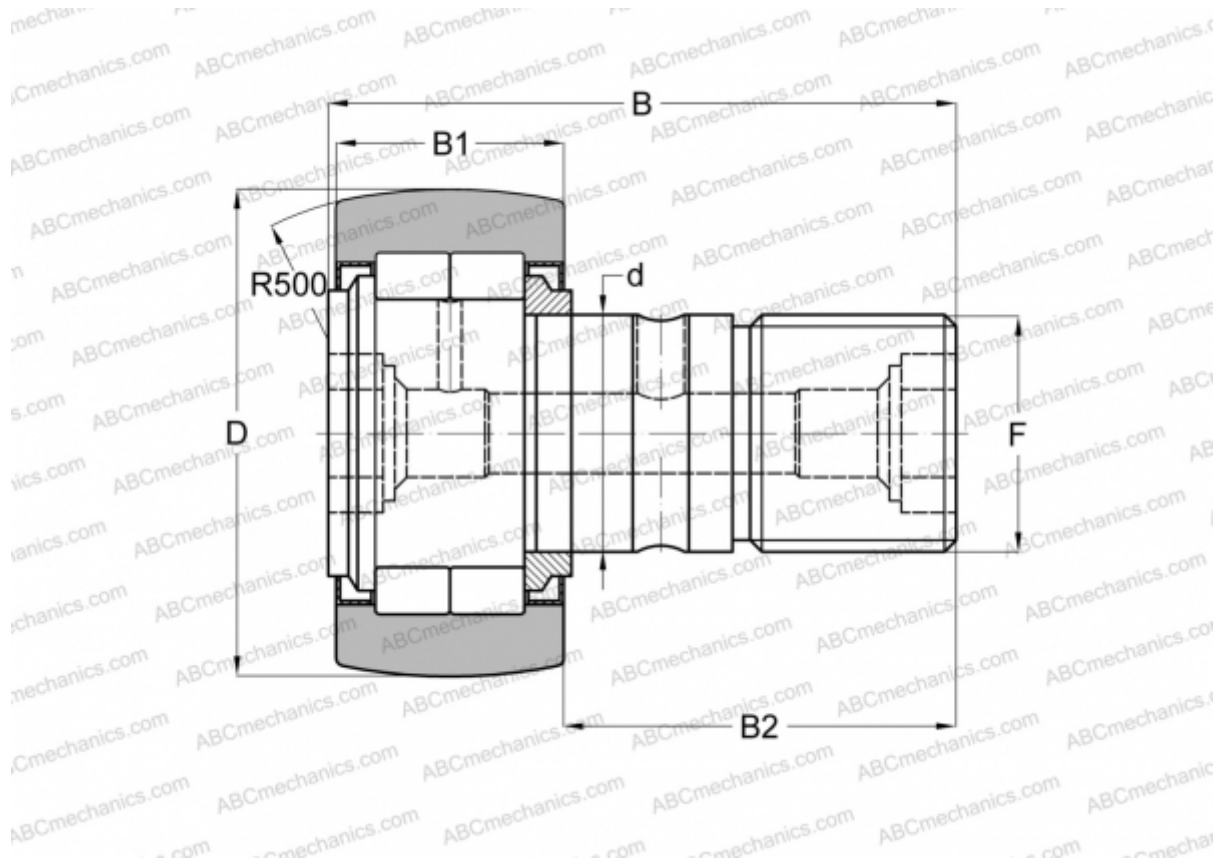

Technical specification

DIMENSIONS, MM

d	24,000
D	72,000
B	80,100
B1	29,000
B2	49,500
F	M24x1.5

WEIGHT, KG 1,020

MANUFACTURER [IKO](#)

INTERCHANGE

ABC	NUKR 72
FAG	NUKR 72 C(NUKD 72)
INA	NUKR 72
McGill	MCFD 72 S

INTERCHANGE

SKF [NUKR 72 A](#)

CALCULATION DATA

Basic dynamic load rating, C	63,900 kN
Basic static load rating, Co	88,800 kN