

## MCFD 72 S McGill

Cam followers

TYPE: Roller bearings, Stud type track rollers, With axial guidance, full complement cylindrical roller set, labyrinth seals on both sides

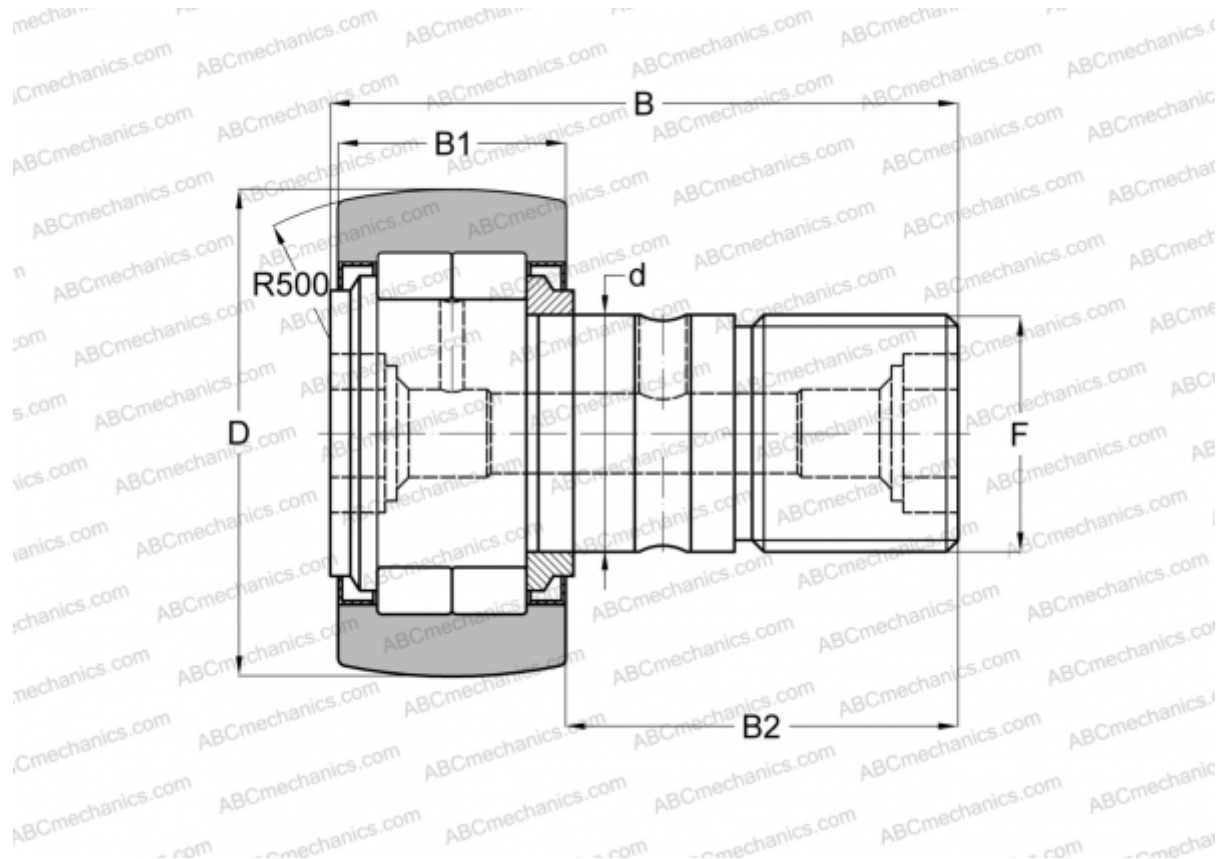

### Technical specification

#### DIMENSIONS, MM

d	24,000
D	72,000
B	80,000
B1	29,000
B2	49,500
F	M24x1.5

**WEIGHT, KG** 1,043

**MANUFACTURER** [McGill](#)

#### INTERCHANGE

ABC	<a href="#">NUKR 72</a>
FAG	<a href="#">NUKR 72 C(NUKD 72)</a>
INA	<a href="#">NUKR 72</a>
IKO	<a href="#">NUCF 24-1 R</a>

#### INTERCHANGE

SKF [NUKR 72 A](#)