

CRSB-28 TORRINGTON

Cam followers

TYPE: Roller bearings, Stud type track rollers, With axial guidance, full complement bearing, sealing rings on both sides, cylindrical outer ring, hex socket, inch size

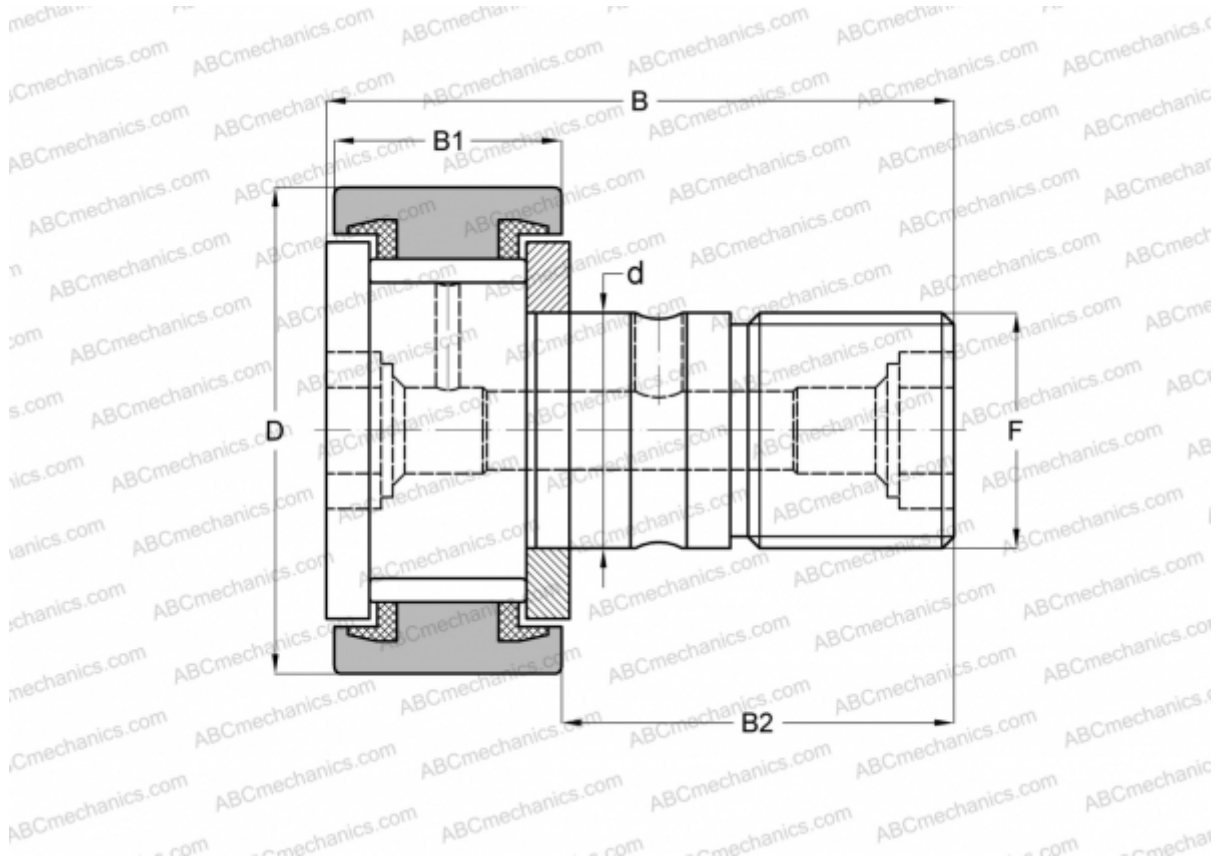

Technical specification

DIMENSIONS, MM

d	19,050
D	44,450
B	70,644
B1	26,194
B2	44,450
F	3/4-16

WEIGHT, KG 0,365

MANUFACTURER [TORRINGTON](#)

INTERCHANGE

ABC	CR 28 VBUU
IKO	CR 28 VBUU
INA	CF 28 PPSK
McGill	CF-1 3/4-SB