

CRY 16 VUUR IKO

Yoke type track roller

TYPE: Roller bearings, Yoke type track rollers, With axial guidance, Full complement needle roller set, sealing rings on both sides, inch size

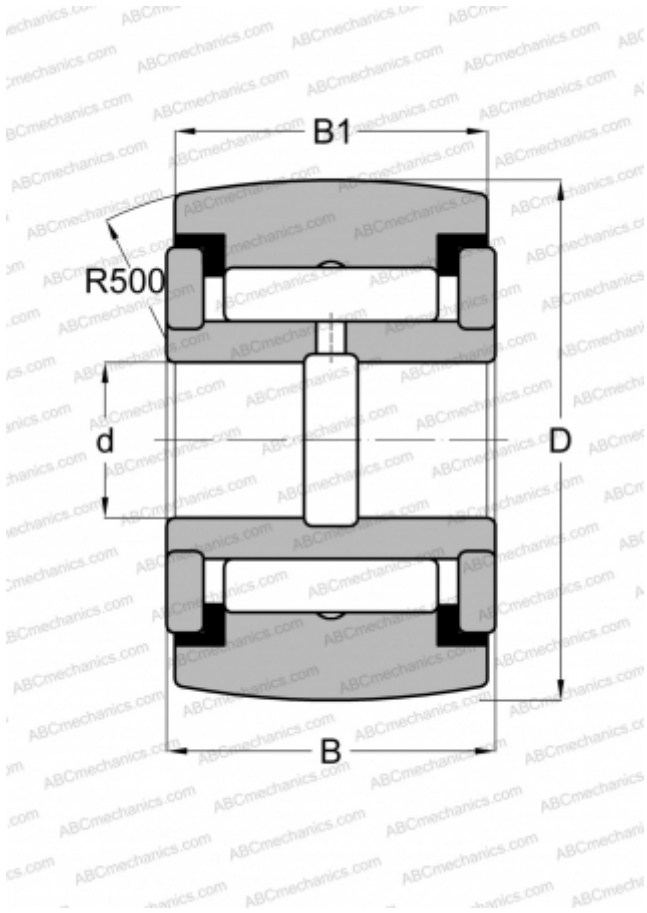

Technical specification

DIMENSIONS, MM

d	7,938
D	25,400
B	17,463
B1	15,875

WEIGHT, KG

0,068

MANUFACTURER

[IKO](#)

INTERCHANGE

ABC	YCRSC 16
INA	RF 16 PPY
McGill	CCYR 1 S
RBC	CY 32 L
SMITH BEARING	YR 1 XC
TORRINGTON	YCRSC 16

CALCULATION DATA

Basic dynamic load rating, C	13,100 kN
Basic static load rating, Co	22,700 kN