

## CRY 36 VUUR IKO

Yoke type track roller

TYPE: Roller bearings, Yoke type track rollers, With axial guidance, Full complement needle roller set, sealing rings on both sides, inch size

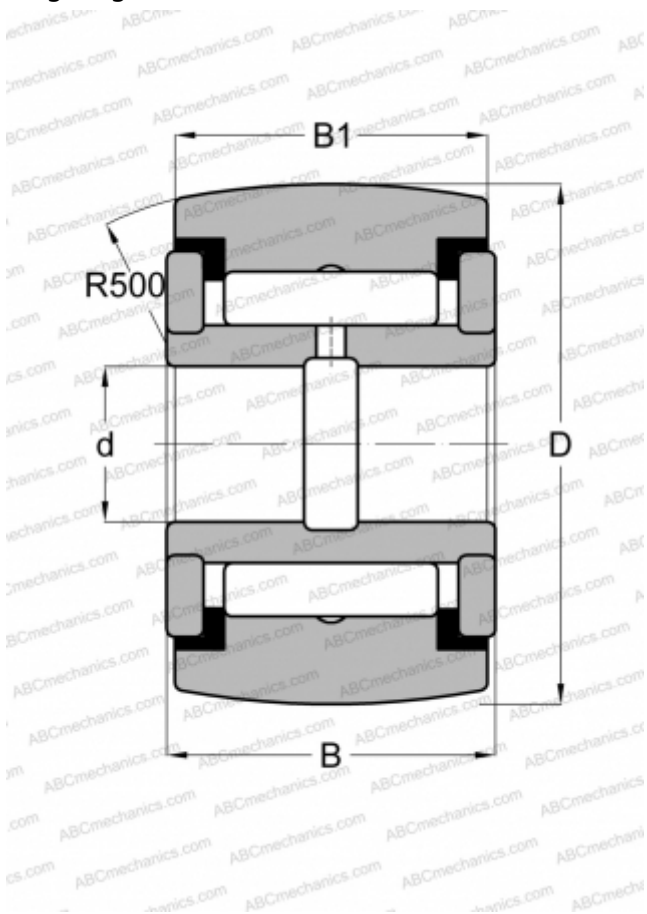

### Technical specification

#### DIMENSIONS, MM

d	15,875
D	57,150
B	33,338
B1	31,750

#### WEIGHT, KG

0,599

#### MANUFACTURER

[IKO](#)

#### INTERCHANGE

ABC	<a href="#">YCRSC 36</a>
INA	<a href="#">RF 36 PPY</a>
McGill	<a href="#">CCYR 2 1/4 S</a>
RBC	<a href="#">CY 72 L</a>
SMITH BEARING	<a href="#">YR 2 1/4 XC</a>
TORRINGTON	<a href="#">YCRSC 36</a>

#### CALCULATION DATA

Basic dynamic load rating, C	45,700 kN
Basic static load rating, Co	80,600 kN