

## SIJ 25 ES SKF

Rod ends

TYPE: Plain bearings, Spherical plain bearings and rod ends, Rod ends, Hydraulic, Requiring maintenance, with thread clamping device, open design, right hand thread, series SIJ..ES, SIQG..ES (SKF)

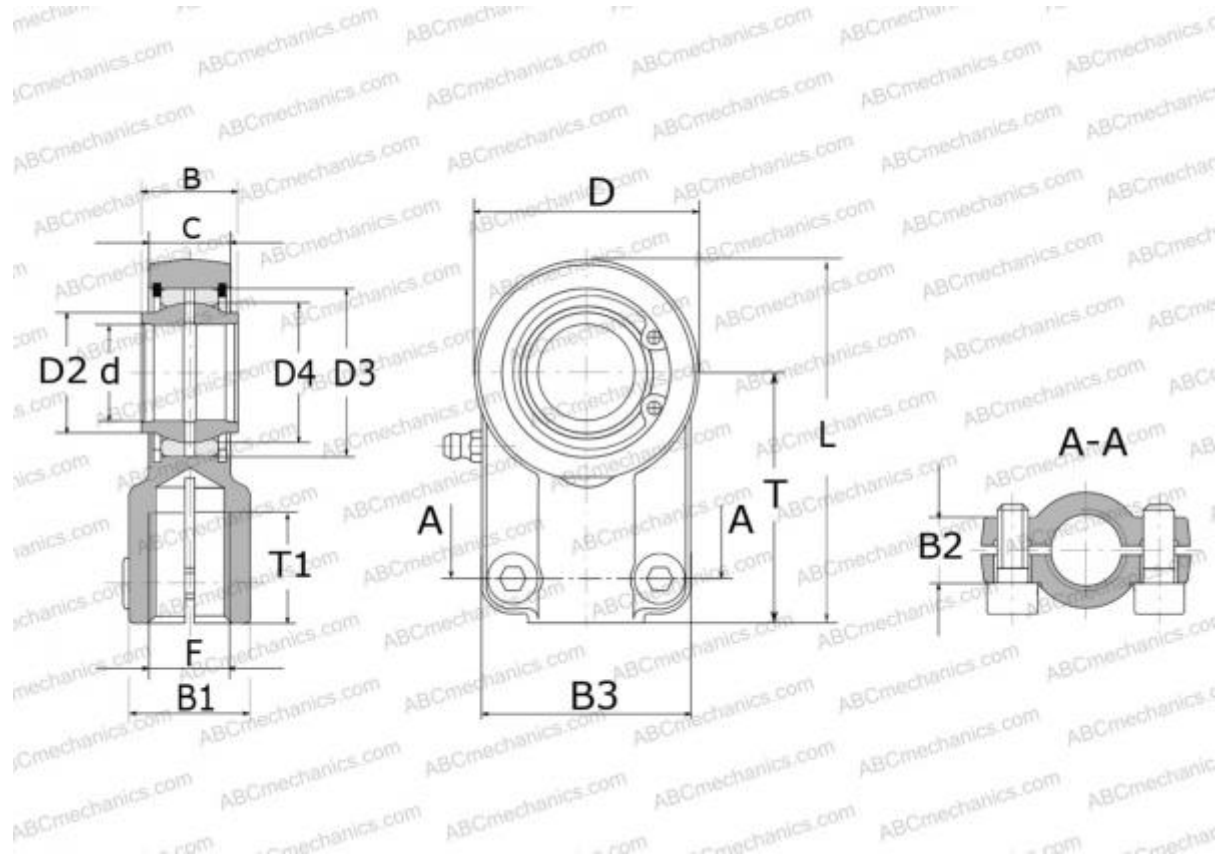

### Technical specification

#### DIMENSIONS, MM

d	25,000
D	65,000
D4	35,500
B	20,000
B1	30,000
B2	17,000
B3	62,000
L	100,500
T	68,000
T1	23,000
C	17,000
F	M16x1.5

#### CALCULATION DATA

Basic dynamic load rating, C	48,000 kN
Basic static load rating, Co	73,500 kN

MANUFACTURER

[SKF](#)