

SILJ 25 ES SKF

Rod ends

TYPE: Plain bearings, Spherical plain bearings and rod ends, Rod ends, Hydraulic, Requiring maintenance, with thread clamping device, open design, left hand thread, series SILJ..ES, SILQG..ES (SKF)

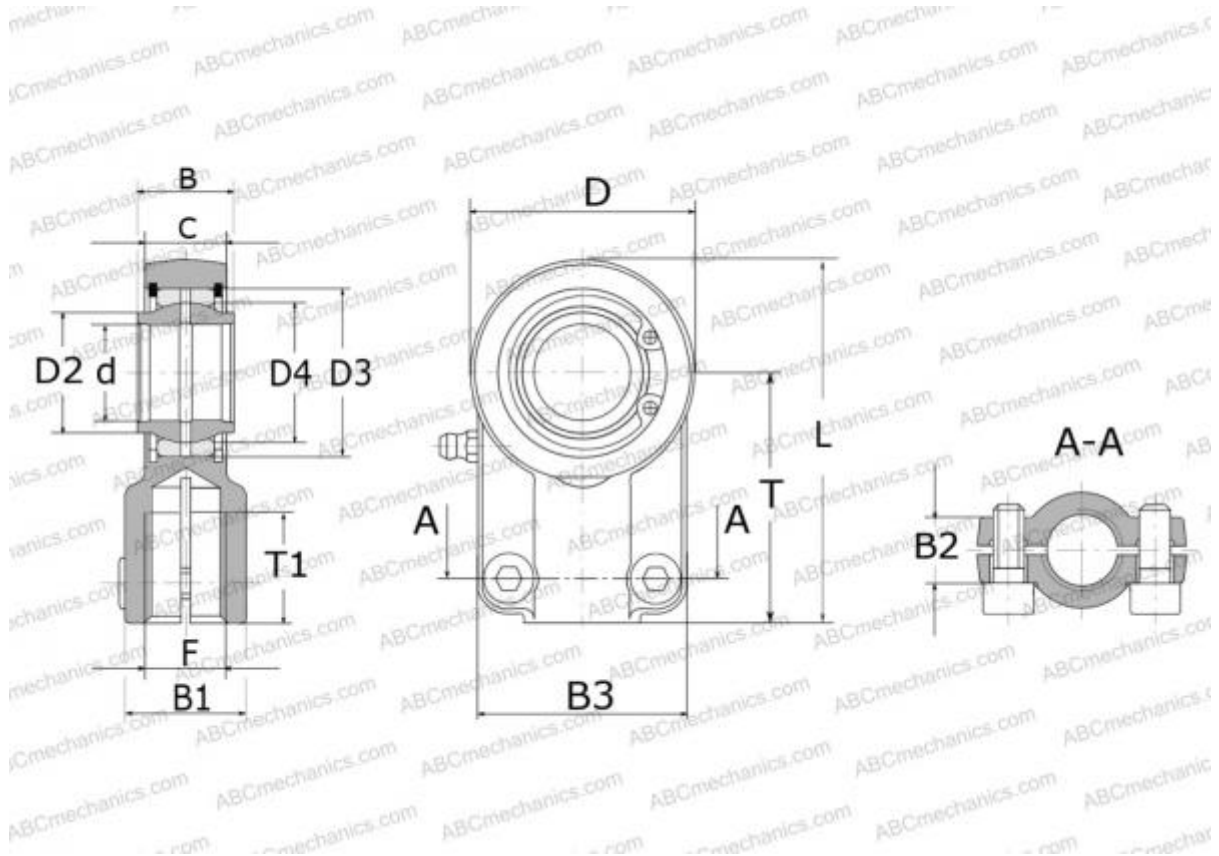

Technical specification

DIMENSIONS, MM

d	25,000
D	65,000
D4	35,500
B	20,000
B1	30,000
B2	17,000
B3	62,000
L	100,500
T	68,000
T1	23,000
C	17,000
F	M16x1.5

CALCULATION DATA

Basic dynamic load rating, C	48,000 kN
Basic static load rating, Co	73,500 kN

MANUFACTURER

[SKF](#)