

SCF25 ES SKF

Rod ends

TYPE: Plain bearings, Spherical plain bearings and rod ends, Rod ends, Hydraulic, Requiring maintenance, with rectangular welding face, open design, series SCF..ES (SKF)

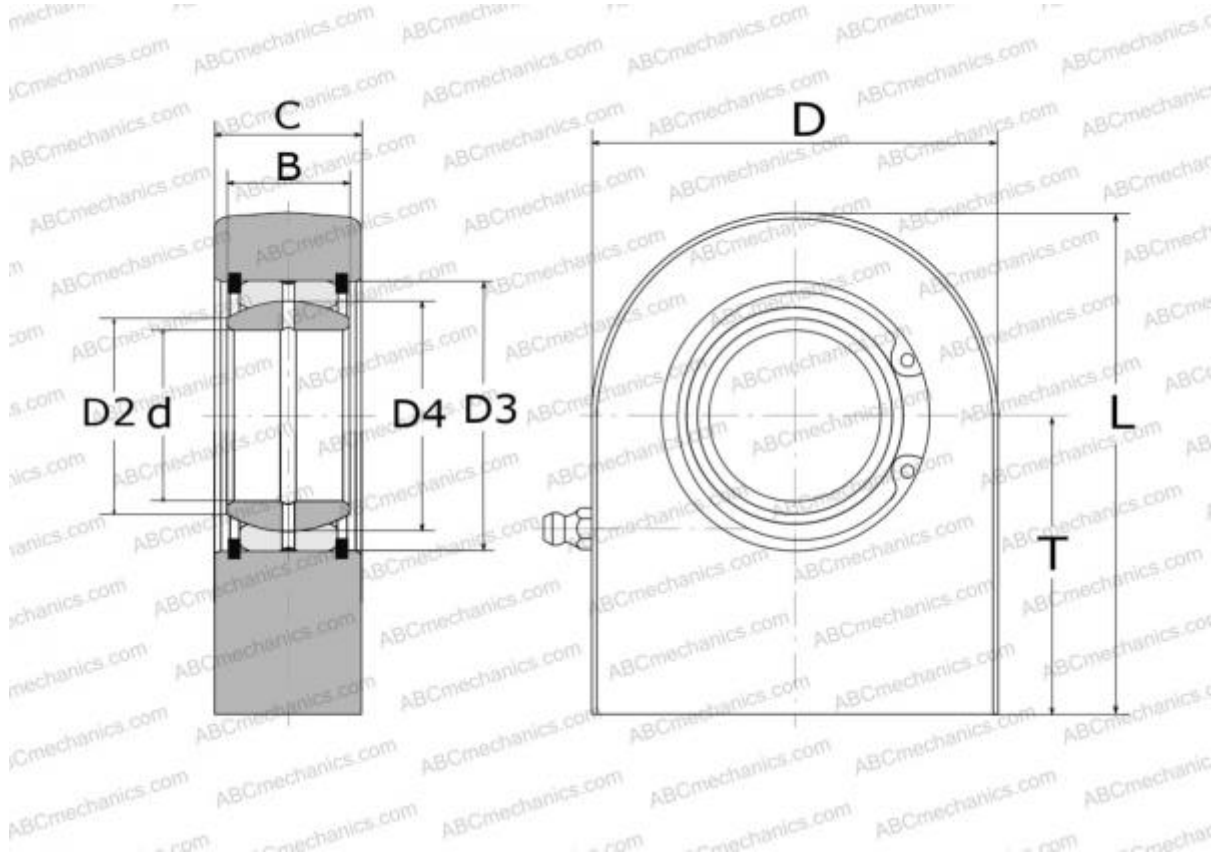

Technical specification

DIMENSIONS, MM

d	25,000
D	56,500
D4	35,500
B	20,000
L	73,500
T	45,000
C	24,000

WEIGHT, KG 0,530

MANUFACTURER [SKF](#)

CALCULATION DATA

Basic dynamic load rating, C	48,000 kN
Basic static load rating, Co	65,500 kN