

SCF 30 ES SKF

Rod ends

TYPE: Plain bearings, Spherical plain bearings and rod ends, Rod ends, Hydraulic, Requiring maintenance, with rectangular welding face, open design, series SCF..ES (SKF)

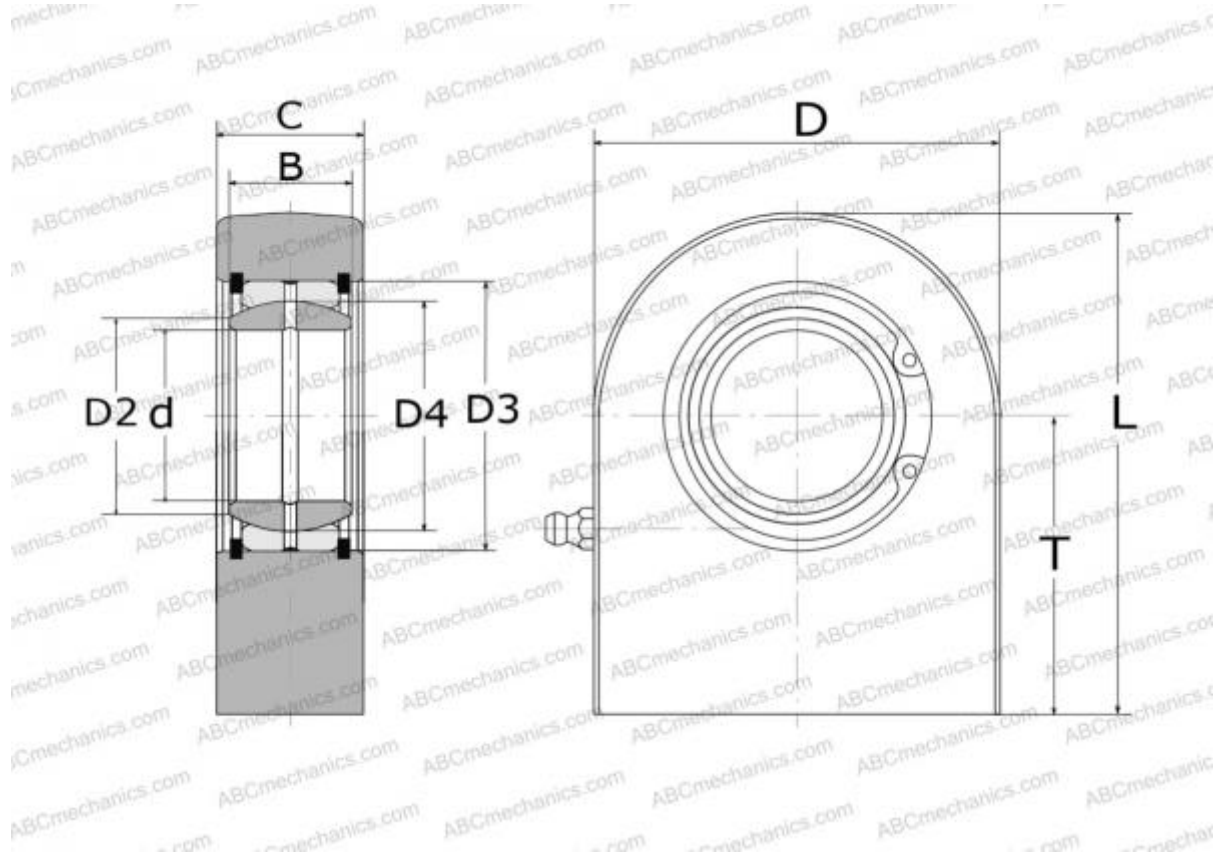

Technical specification

DIMENSIONS, MM

d	30,000
D	66,500
D4	40,700
B	22,000
L	85,000
T	51,000
C	29,000

WEIGHT, KG 0,870

MANUFACTURER [SKF](#)

CALCULATION DATA

Basic dynamic load rating, C	62,000 kN
Basic static load rating, Co	110,000 kN