

SCF 35 ES SKF

Rod ends

TYPE: Plain bearings, Spherical plain bearings and rod ends, Rod ends, Hydraulic, Requiring maintenance, with rectangular welding face, open design, series SCF..ES (SKF)

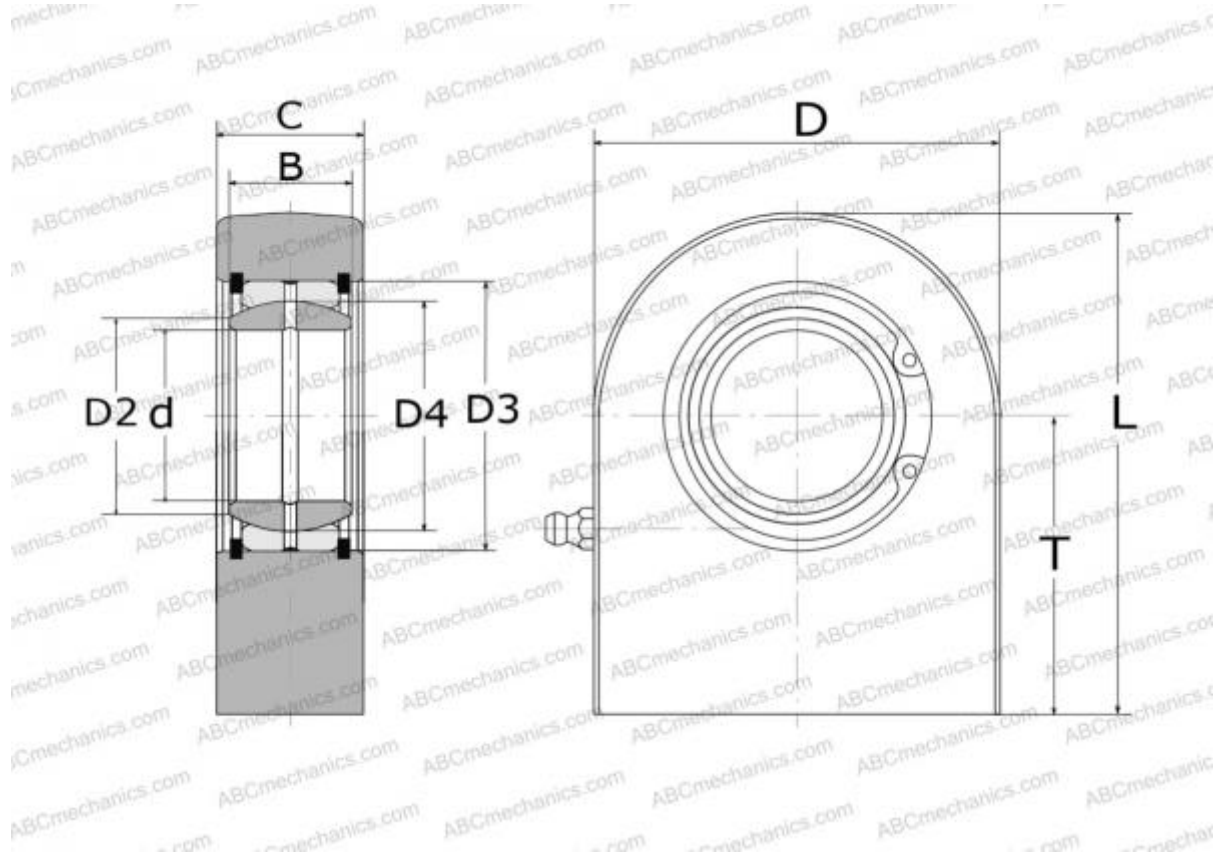

Technical specification

DIMENSIONS, MM

d	35,000
D	85,000
D4	47,000
B	25,000
L	103,500
T	61,000
C	31,000

WEIGHT, KG 1,550

MANUFACTURER [SKF](#)

CALCULATION DATA

Basic dynamic load rating, C	80,000 kN
Basic static load rating, Co	183,000 kN