

SCF 60 ES SKF

Rod ends

TYPE: Plain bearings, Spherical plain bearings and rod ends, Rod ends, Hydraulic, Requiring maintenance, with rectangular welding face, open design, series SCF..ES (SKF)

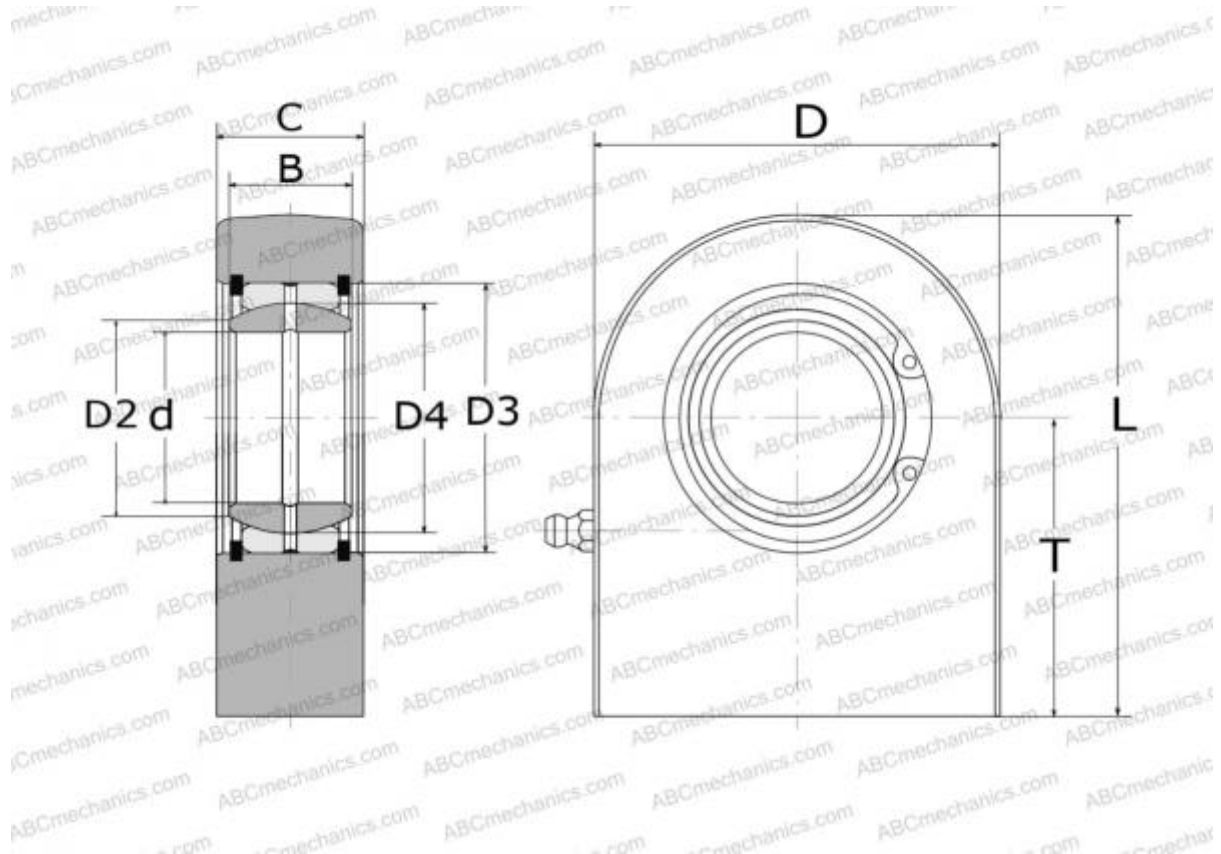

Technical specification

DIMENSIONS, MM

d	60,000
D	142,500
D4	80,000
B	44,000
L	171,500
T	100,000
C	51,500

WEIGHT, KG 7,000

MANUFACTURER [SKF](#)

CALCULATION DATA

Basic dynamic load rating, C	245,000 kN
Basic static load rating, Co	530,000 kN