

GK 17 DO INA

TYPE: Plain bearings, Spherical plain bearings and rod ends, Rod ends, Hydraulic, Requiring maintenance, with circular welding face, open design, DIN ISO 12240-4, series GK.-DO (INA)

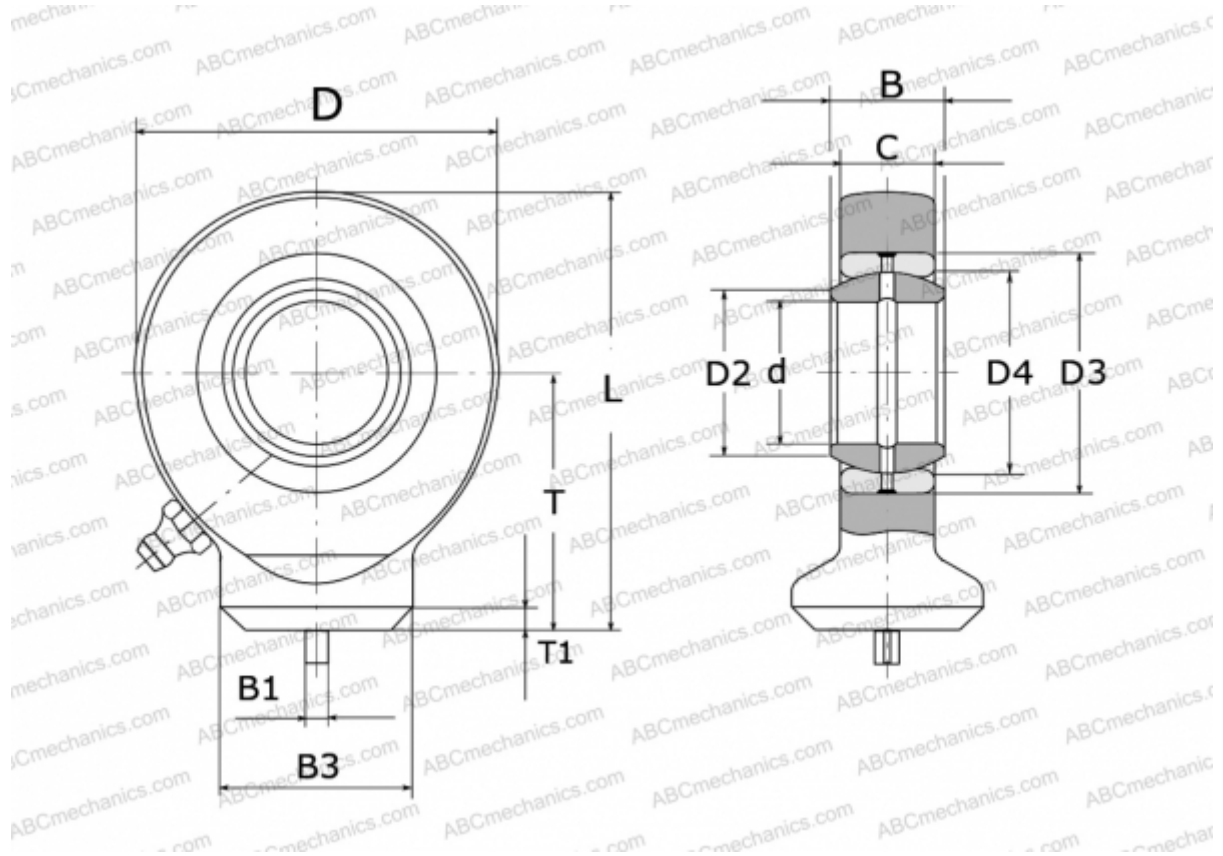

Technical specification

DIMENSIONS, MM

d	17,000
D	46,000
D2	20,700
D3	30,000
D4	25,000
B	14,000
B1	4,000
B3	24,000
L	58,000
T	35,000
T1	3,000
C	11,000

MANUFACTURER

[INA](#)