

NUKRE40-X INA

Cam followers

TYPE: Roller bearings, Stud type track rollers, With axial guidance, full complement cylindrical roller set, with eccentric collar, labyrinth seals on both sides, cylindrical outer ring

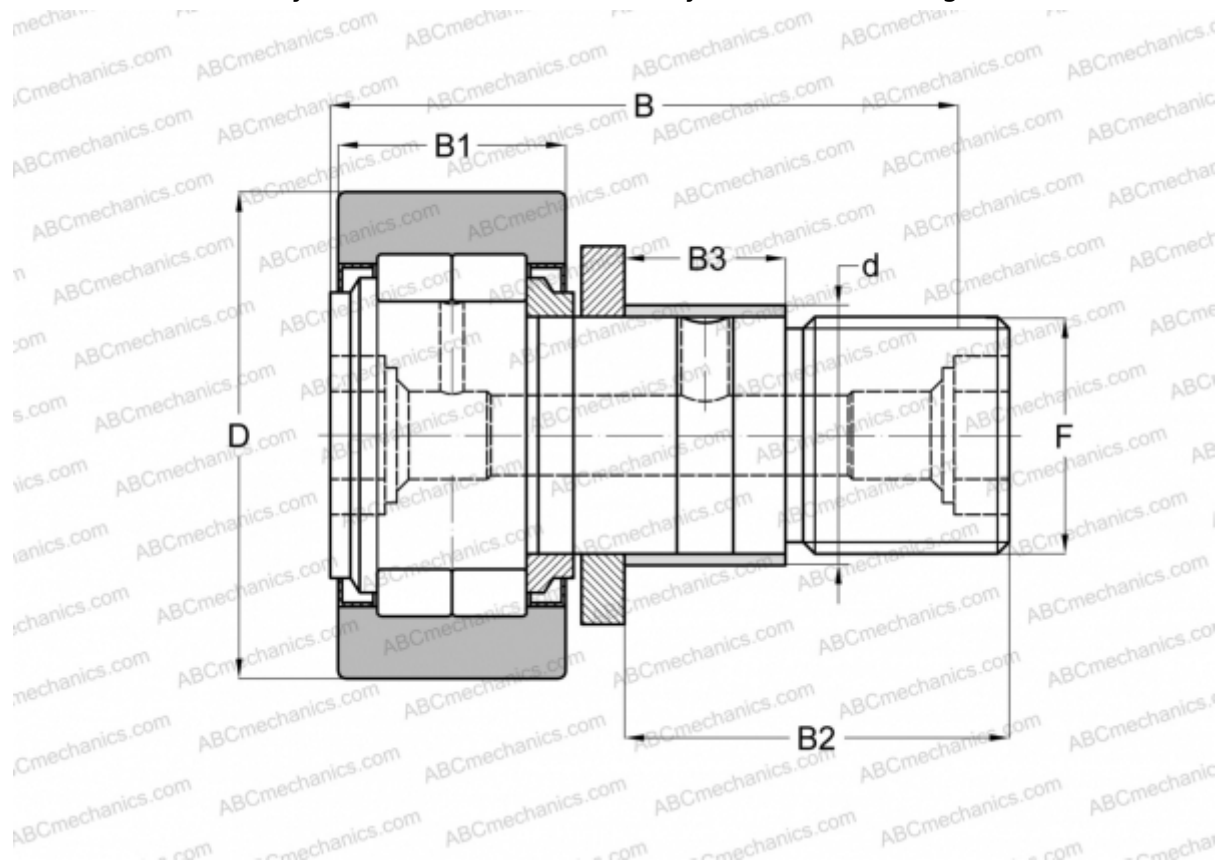

Technical specification

DIMENSIONS, MM

d	18,000
D	40,000
B	58,000
B1	24,000
B2	33,000
F	M18X1,5

CALCULATION DATA

Fatigue load limit, Pu	3,150 kN
Limiting speed	5500 r/min

MANUFACTURER

[INA](#)

INTERCHANGE

ABC	NUKRE 40 X
FAG	NUKRE 40 C DZ
SKF	NUKRE 40 X

CALCULATION DATA

Basic dynamic load rating, C	18,700 kN
Basic static load rating, Co	24,900 kN