

## CUS205 SNR

Insert bearings

TYPE: Ball bearings, Radial insert bearings, Grub screw to inner ring, Cylindrical outer ring, snap ring, Seals on both side, with inner ring extended at one side

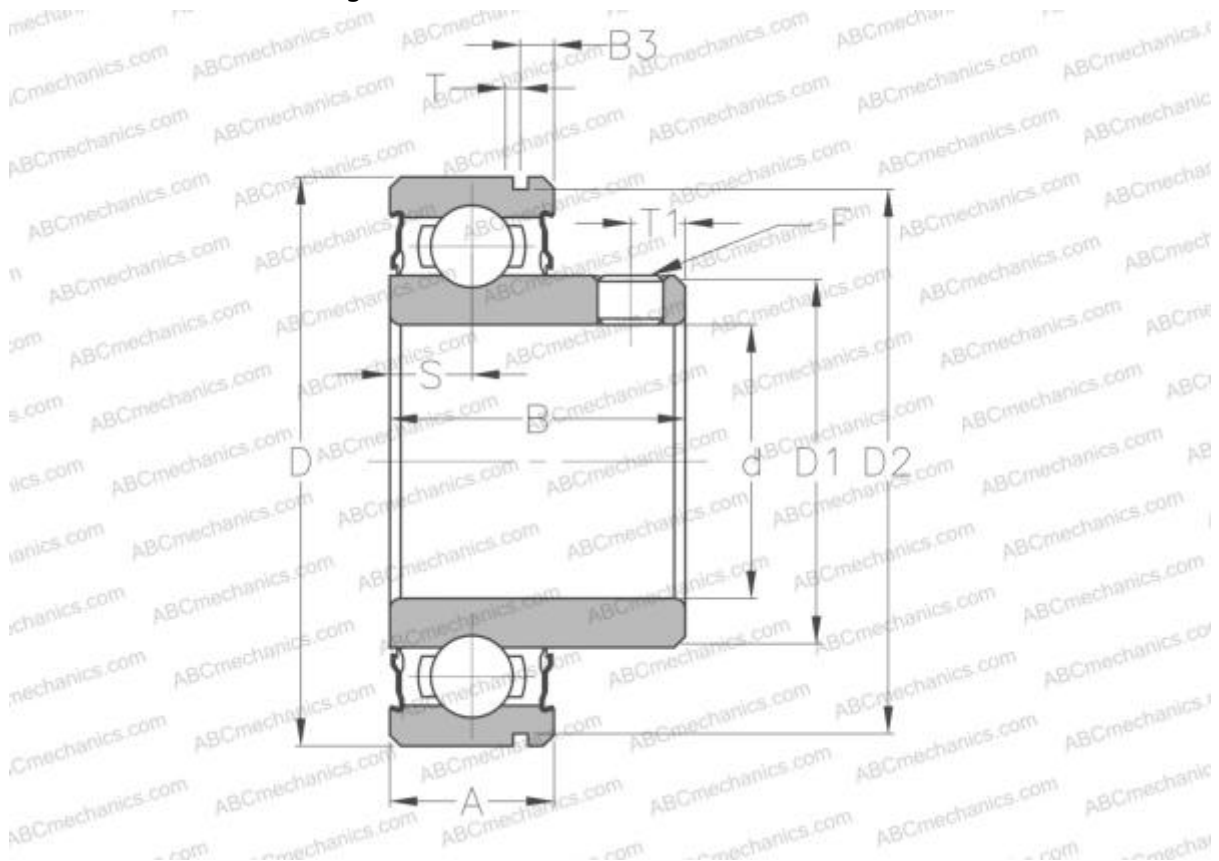

### Technical specification

#### DIMENSIONS, MM

d	25,000
D	52,000
D1	34,000
B	27,000
B1	15,000
c	7,500
T1	5,000
F	M6 x 1

#### MANUFACTURER

[SNR](#)

#### CALCULATION DATA

Basic dynamic load rating, C	14,000 kN
Basic static load rating, Co	7,880 kN
Operating temperature min	-20 °C
Operating temperature max	110 °C