

UK205+H SNR

Insert bearings

TYPE: Ball bearings, Radial insert bearings, With adapter sleeve, Spherical outer ring, Seals on both side, RSR seal, relubrication

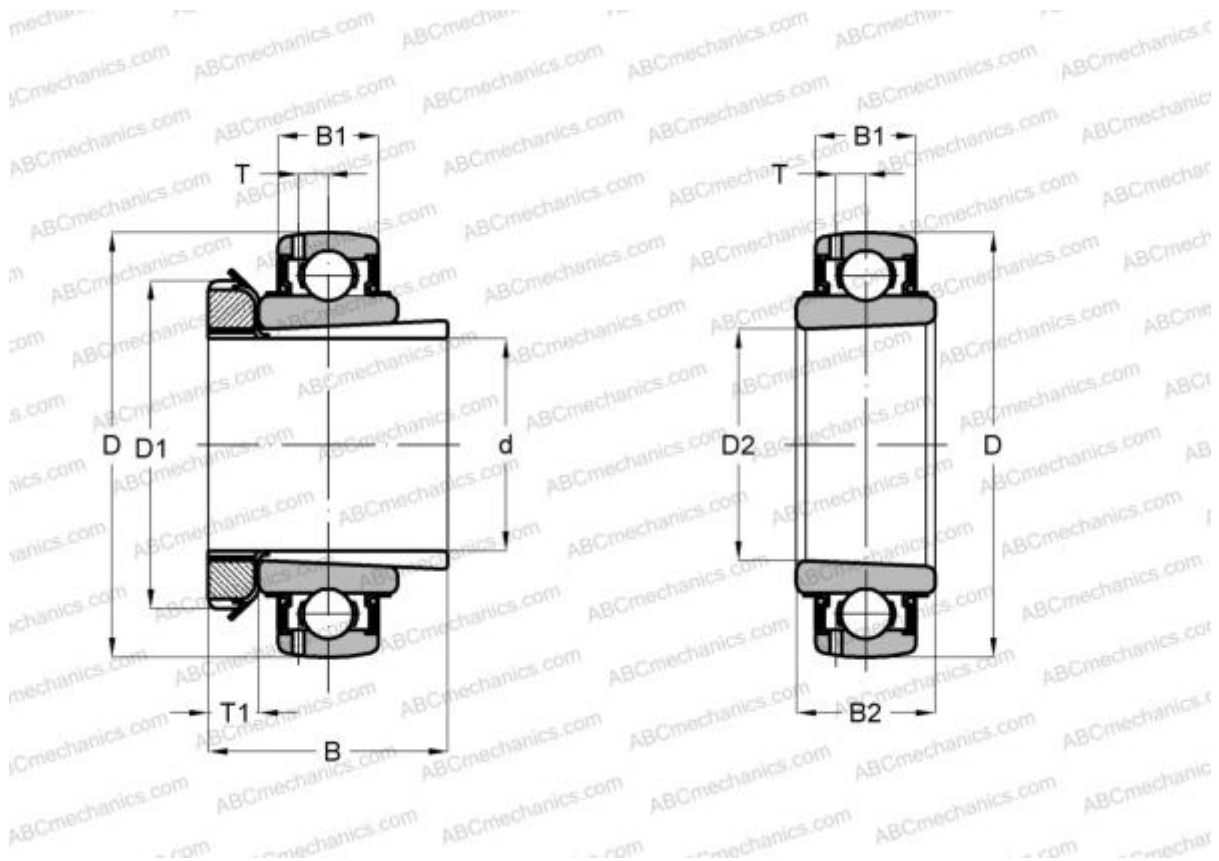

Technical specification

DIMENSIONS, MM

d	20,000
D	52,000
D1	38,000
D2	25,000
B	35,000
B1	17,000
B2	21,000
T	4,300
T1	8,000

MANUFACTURER

[SNR](#)

INTERCHANGE

ABC	UK 205 + H2305
SKF	YSA 205-2FK
ASAHI	UK 205 + H2305

INTERCHANGE

FKL	LK 205 2F
SLB	UK205
FYH	UK 205
NTN	UK 205 D1

CALCULATION DATA

Basic dynamic load rating, C	14,000 kN
Basic static load rating, Co	7,880 kN
Operating temperature min	-20 °C
Operating temperature max	110 °C



INCLUDED PRODUCTS

H2305

