

GFR 20 F3F4 STIEBER

Freewheel

TYPE: Freewheel, Self-contained freewheels, Roller type freewheels, using two 160.. series bearings, require oil lubrication, with flange type 3,4

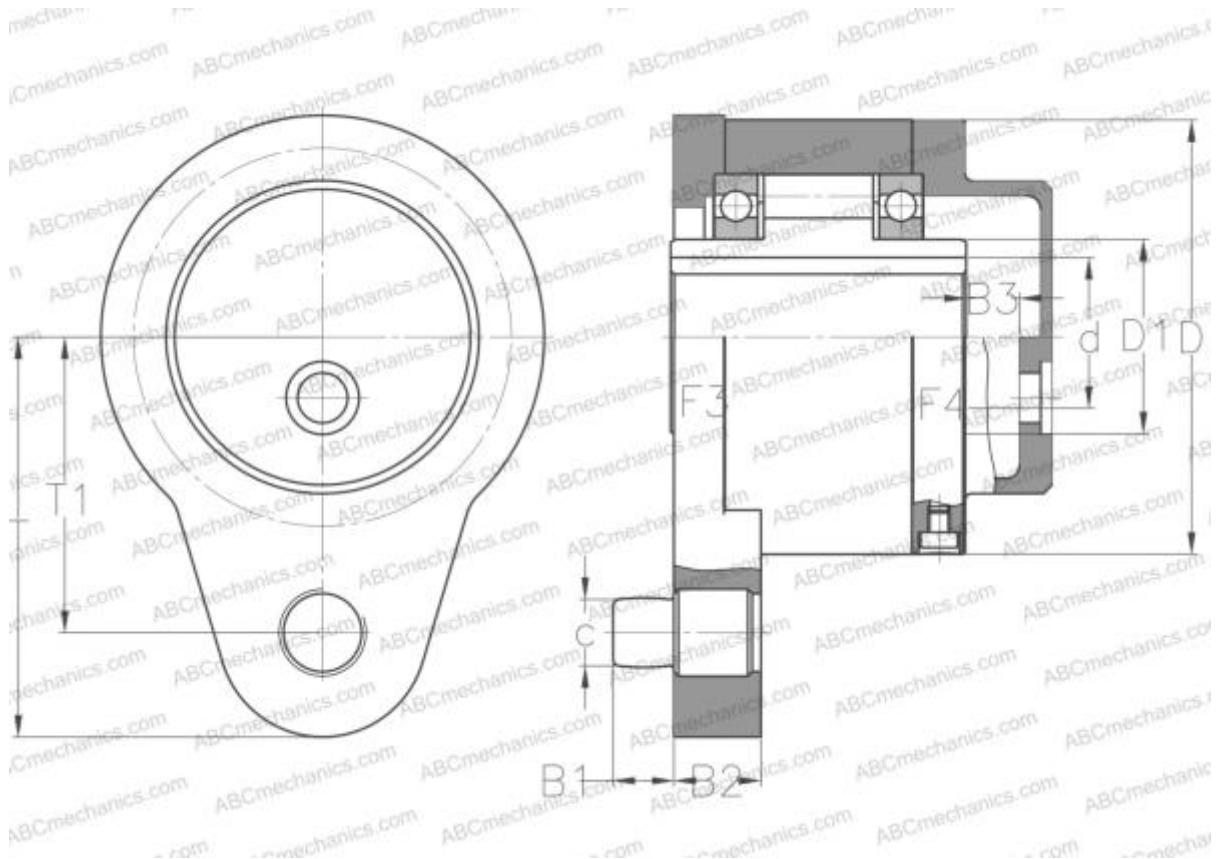

Technical specification

DIMENSIONS, MM

d	20,000
D	75,000
D1	30,000
B	82,000
B1	11,000
B2	15,000
B3	10,000
c	12,000
T	72,000
T1	54,000

MANUFACTURER

[STIEBER](#)

INTERCHANGE

ABC [GFR 20 F3F4](#)