

GFR 25 F3F4 STIEBER

Freewheel

TYPE: Freewheel, Self-contained freewheels, Roller type freewheels, using two 160.. series bearings, require oil lubrication, with flange type 3,4

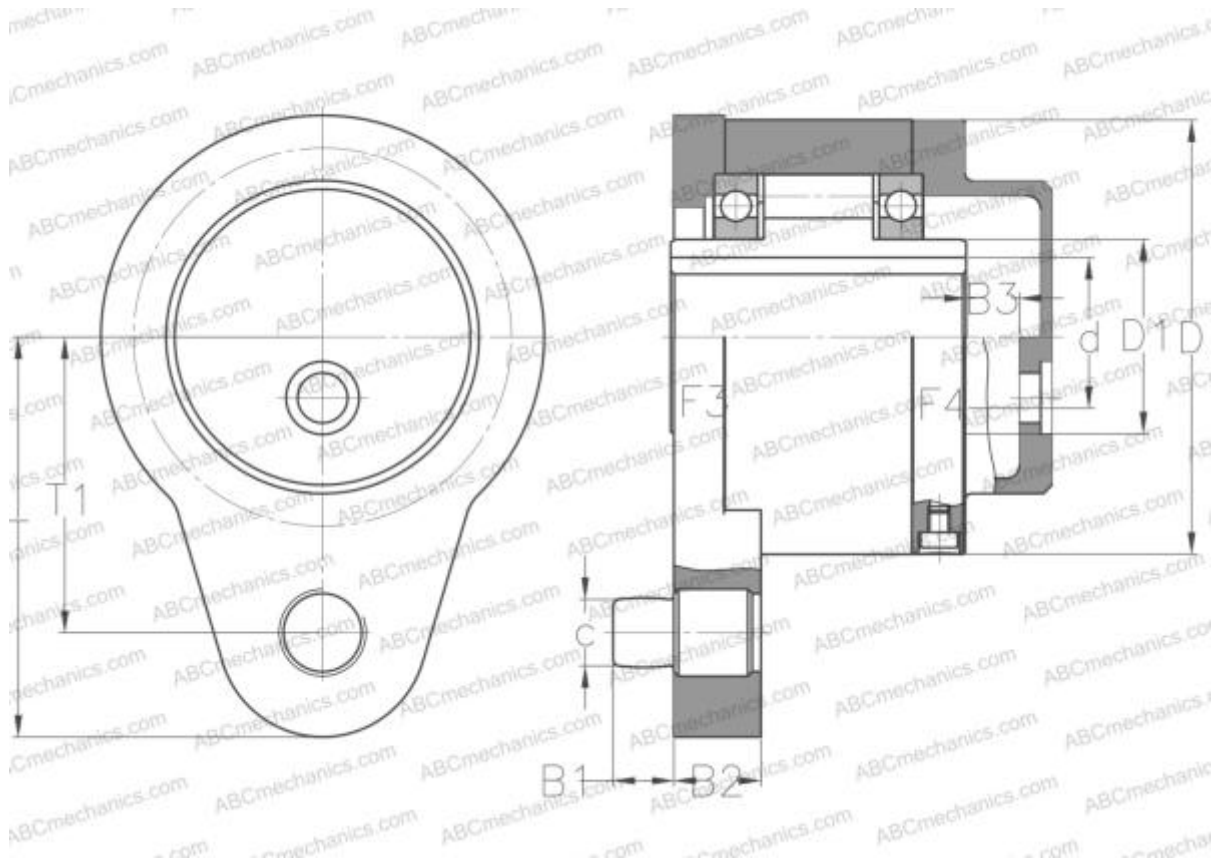

Technical specification

DIMENSIONS, MM

d	25,000
D	90,000
D1	40,000
B	85,000
B1	14,000
B2	18,000
B3	10,000
c	16,000
T	84,000
T1	62,000

MANUFACTURER [STIEBER](#)

INTERCHANGE

ABC [GFR 25 F3F4](#)