

## AL 20 STIEBER

Freewheel

TYPE: Freewheel, Self-contained freewheels, Roller type freewheels, using two 160.. series bearings, require oil lubrication, through holes for mounting

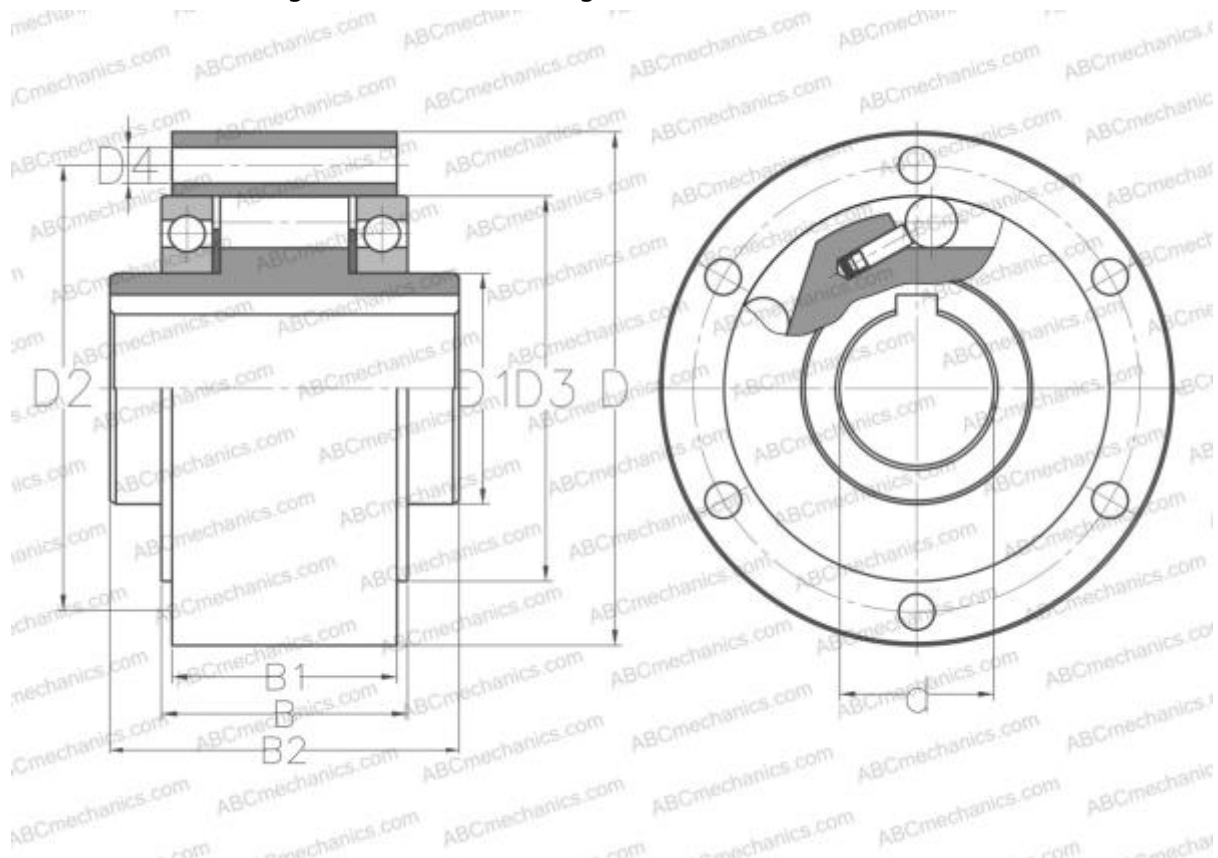

### Technical specification

#### DIMENSIONS, MM

d	20,000
D	75,000
D1	30,000
D2	64,000
D3	55,000
D4	5,500
B	39,100
B1	34,300
B2	57,000

**MANUFACTURER** [STIEBER](#)

#### INTERCHANGE

ABC [AL 20](#)