

ALP 20 STIEBER

Freewheel

TYPE: Freewheel, Self-contained freewheels, Roller type freewheels, using two 160.. series bearings, require oil lubrication, through holes for mounting, keyway on the outside diameter

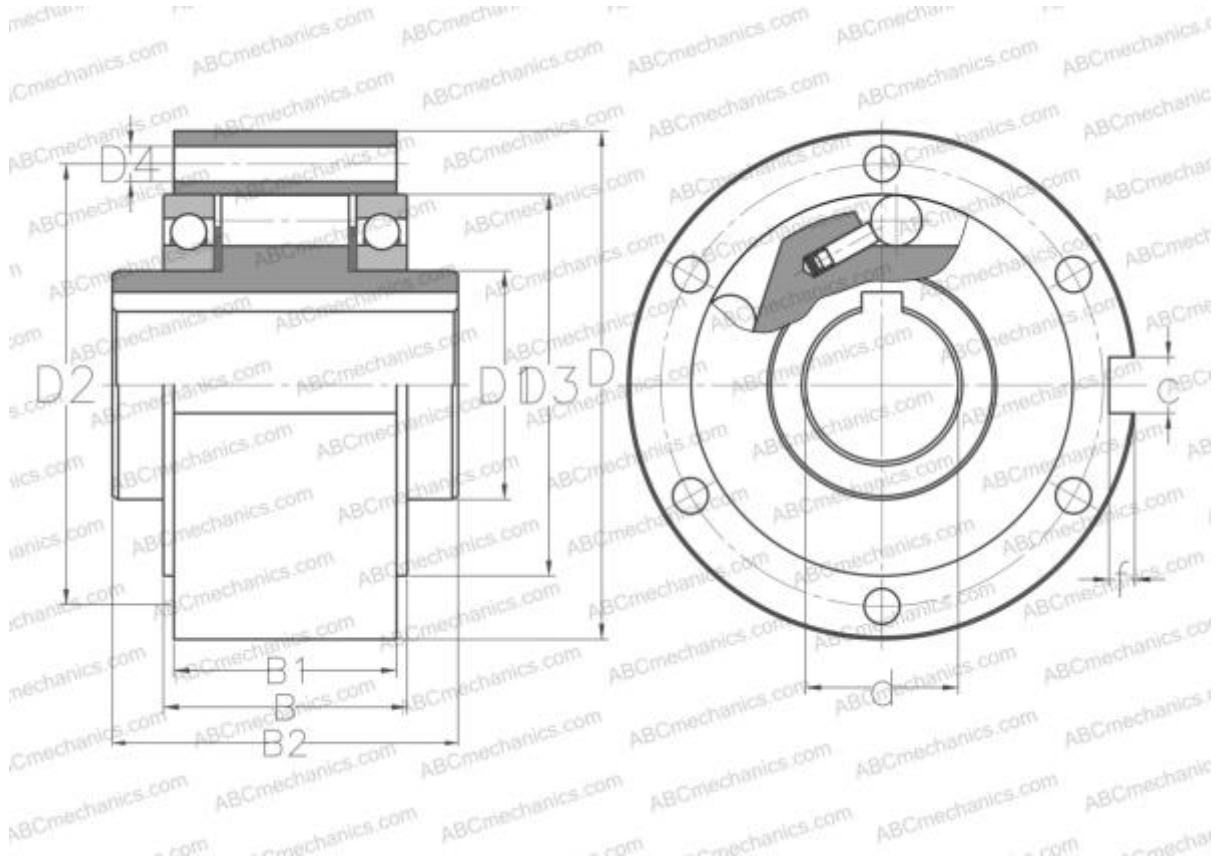

Technical specification

DIMENSIONS, MM

d	20,000
D	75,000
D1	30,000
D2	64,000
D3	55,000
D4	5,500
B	39,100
B1	34,300
B2	57,000
f	3,500
c	6,000

MANUFACTURER [STIEBER](#)

INTERCHANGE

ABC [ALP 20](#)