

LBE 16 IKO

Linear bushing

TYPE: Shaft guidance systems, Linear bushing, Standard, Close type, Type LBE

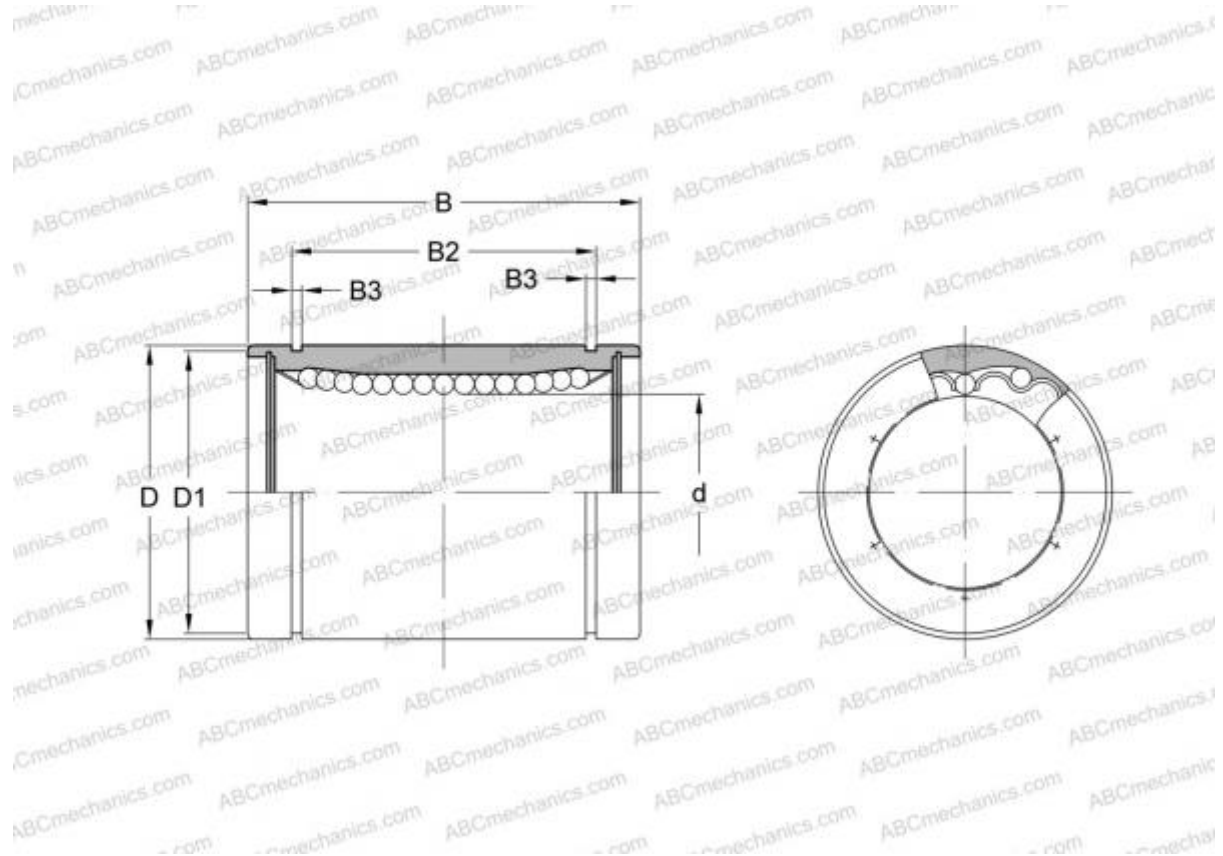

Technical specification

DIMENSIONS, MM

d	16,000
D	26,000
B	36,000

WEIGHT, KG 0,047

MANUFACTURER [IKO](#)

INTERCHANGE

ABC	LBE 16
STAR	0600-016-00
THOMSON	0600-016-00
INA	KB 1636
SKF	LBCR 16
FAG	LAA 16x26x36

CALCULATION DATA

Basic dynamic load rating min	0,311 kN
Basic dynamic load rating max	0,357 kN
Basic static load rating min	0,587 kN
Basic static load rating max	0,830 kN