

LBE 30 IKO

Linear bushing

TYPE: Shaft guidance systems, Linear bushing, Standard, Close type, Type LBE

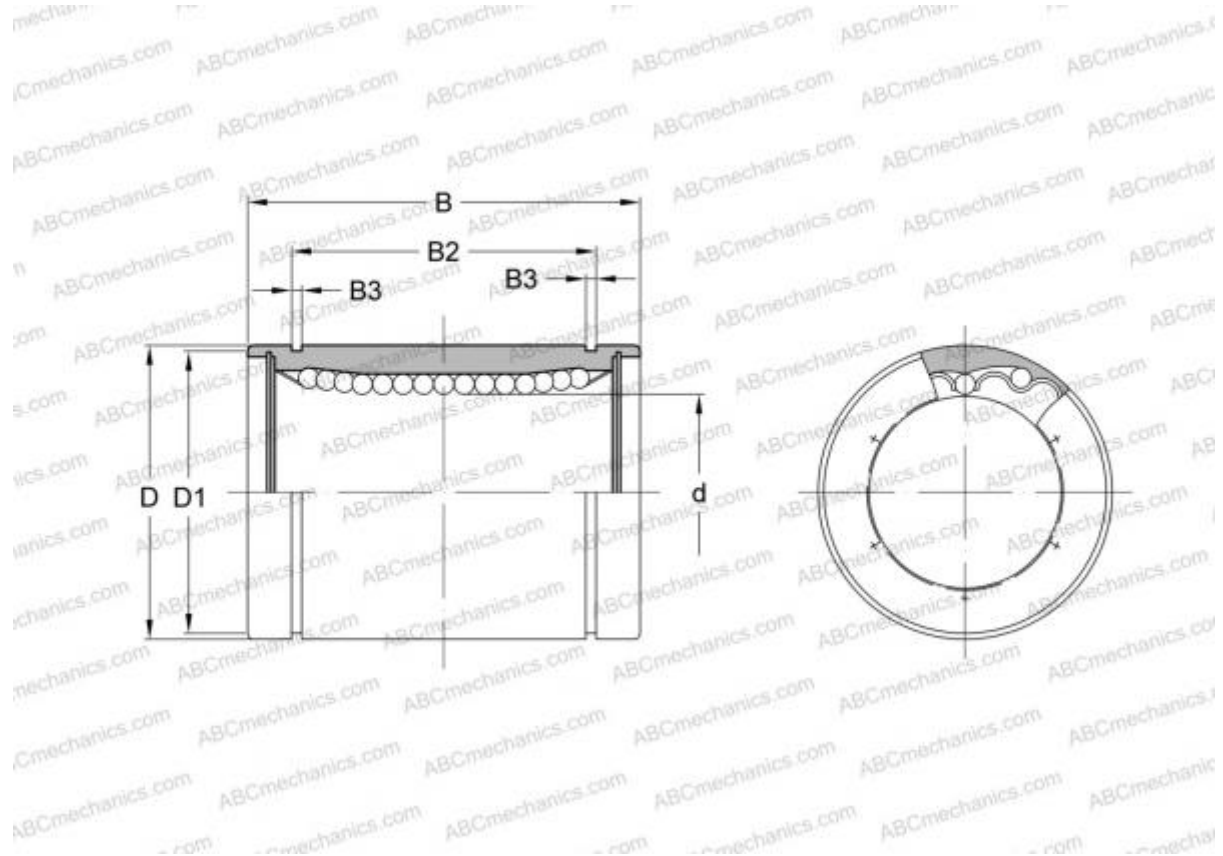

Technical specification

DIMENSIONS, MM

d	30,000
D	47,000
B	68,000

WEIGHT, KG 0,305

MANUFACTURER [IKO](#)

INTERCHANGE

ABC	LBE 30
STAR	0600-030-00
THOMSON	0600-030-00
INA	KB 3068
SKF	LBCR 30
FAG	LAA 30x47x68

CALCULATION DATA

Basic dynamic load rating min	1,560 kN
Basic dynamic load rating max	1,650 kN
Basic static load rating min	3,060 kN
Basic static load rating max	3,910 kN