

LBE 25 AJ IKO

Linear bushing

TYPE: Shaft guidance systems, Linear bushing, Standard, Adjustable type, Type LBE..AJ

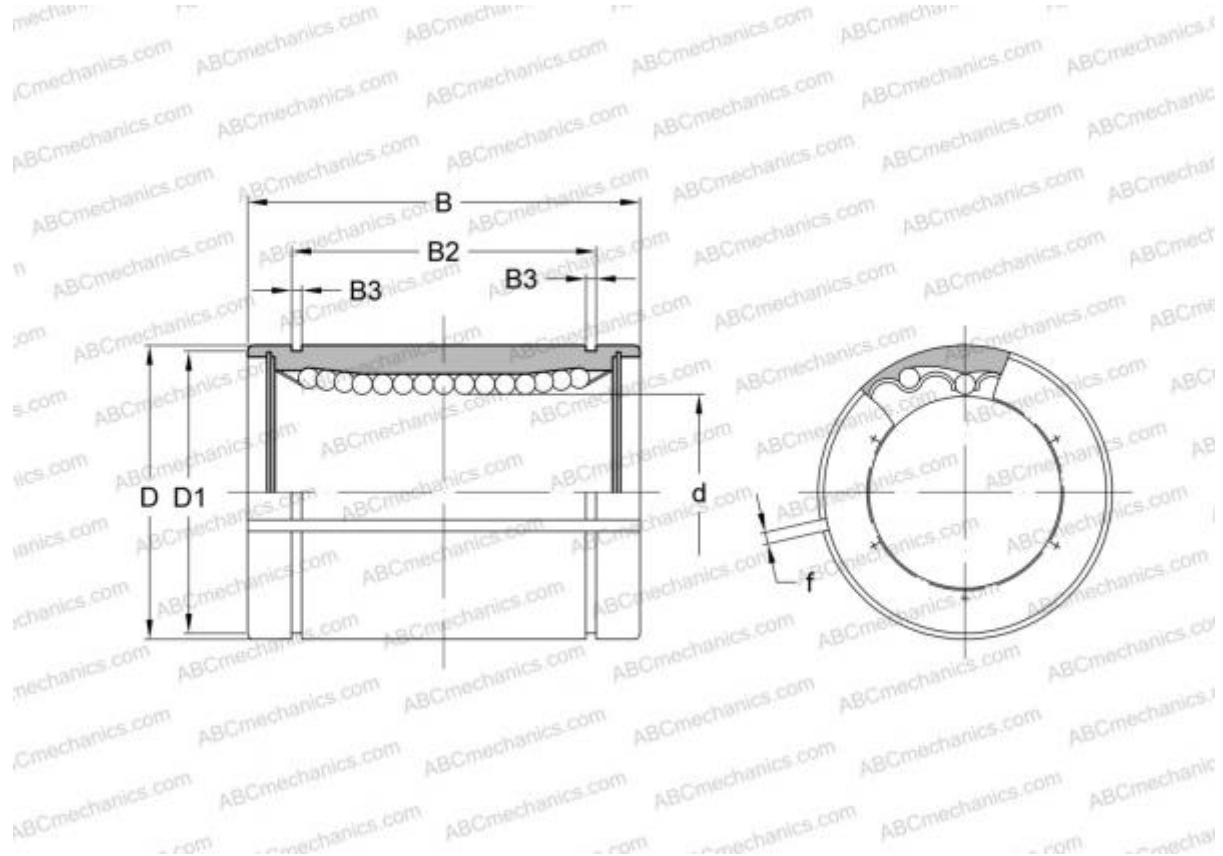

Technical specification

DIMENSIONS, MM

d	25,000
D	40,000
B	58,000
f	2,000

WEIGHT, KG 0,159

MANUFACTURER [IKO](#)

INTERCHANGE

ABC	LBE 25 AJ
STAR	0610-025-00
THOMSON	0610-025-00
INA	KBS 2558
FAG	LAG 25x40x58

CALCULATION DATA

Basic dynamic load rating min	1,070 kN
Basic dynamic load rating max	1,270 kN
Basic static load rating min	2,020 kN
Basic static load rating max	2,960 kN