

LBE 30 AJ IKO

Linear bushing

TYPE: Shaft guidance systems, Linear bushing, Standard, Adjustable type, Type LBE..AJ

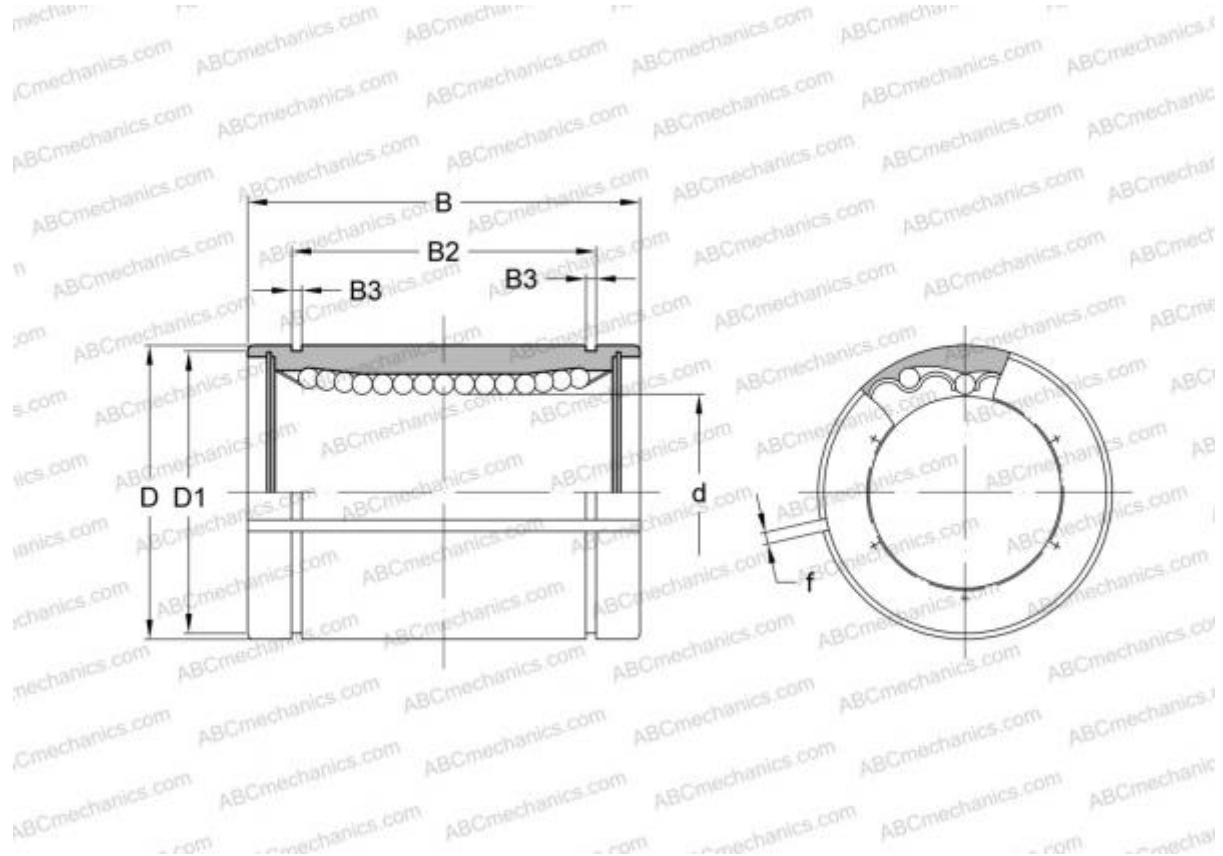

Technical specification

DIMENSIONS, MM

d	30,000
D	47,000
B	68,000
f	2,000

WEIGHT, KG 0,300

MANUFACTURER [IKO](#)

INTERCHANGE

ABC	LBE 30 AJ
STAR	0610-030-00
THOMSON	0610-030-00
INA	KBS 3068
FAG	LAG 30x47x68

CALCULATION DATA

Basic dynamic load rating min	1,560 kN
Basic dynamic load rating max	1,650 kN
Basic static load rating min	3,060 kN
Basic static load rating max	3,910 kN