

LBE 20 UU IKO

Linear bushing

TYPE: Shaft guidance systems, Linear bushing, Standard, Close type, Type LBE..UU, KB..PP, LBCR..2LS, sealed on both sides

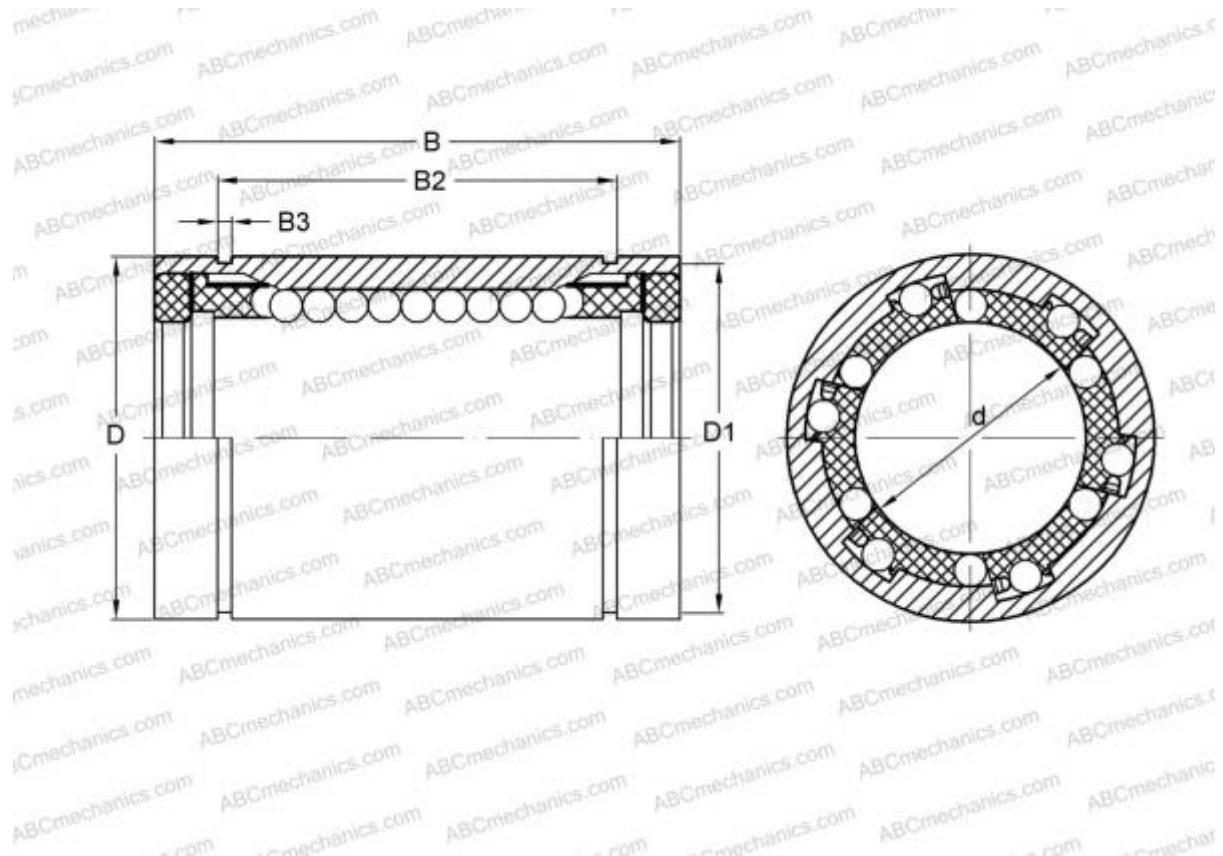

Technical specification

DIMENSIONS, MM

d	20,000
D	32,000
B	45,000

WEIGHT, KG 0,085

MANUFACTURER [IKO](#)

INTERCHANGE

ABC	LBE 20 UU
STAR	0602-020-10
THOMSON	0602-020-10
INA	KB20-PP
SKF	LBCR 20-2LS
FAG	LAA 20x32x45.2RS

CALCULATION DATA

Basic dynamic load rating min	0,617 kN
Basic dynamic load rating max	0,734 kN
Basic static load rating min	1,150 kN
Basic static load rating max	1,680 kN