

LBE 25 UU IKO

Linear bushing

TYPE: Shaft guidance systems, Linear bushing, Standard, Close type, Type LBE..UU, KB..PP, LBCR..2LS, sealed on both sides

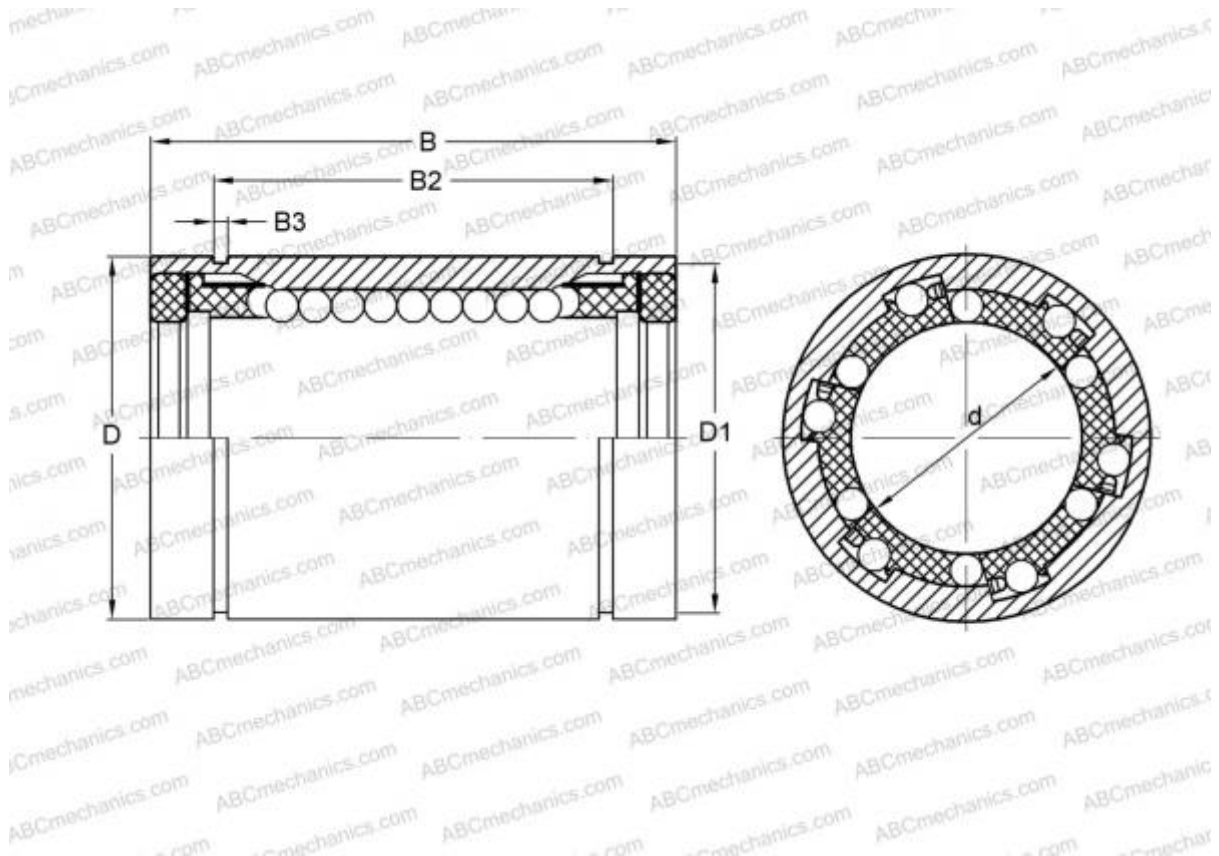

Technical specification

DIMENSIONS, MM

d	25,000
D	40,000
B	58,000

WEIGHT, KG 0,162

MANUFACTURER [IKO](#)

INTERCHANGE

ABC	LBE 25 UU
STAR	0602-025-10
THOMSON	0602-025-10
INA	KB25-PP
SKF	LBCR 25-2LS
FAG	LAA 25x40x58.2RS

CALCULATION DATA

Basic dynamic load rating min	1,070 kN
Basic dynamic load rating max	1,270 kN
Basic static load rating min	2,020 kN
Basic static load rating max	2,960 kN