

LBE 30 UU IKO

Linear bushing

TYPE: Shaft guidance systems, Linear bushing, Standard, Close type, Type LBE..UU, KB..PP, LBCR..2LS, sealed on both sides

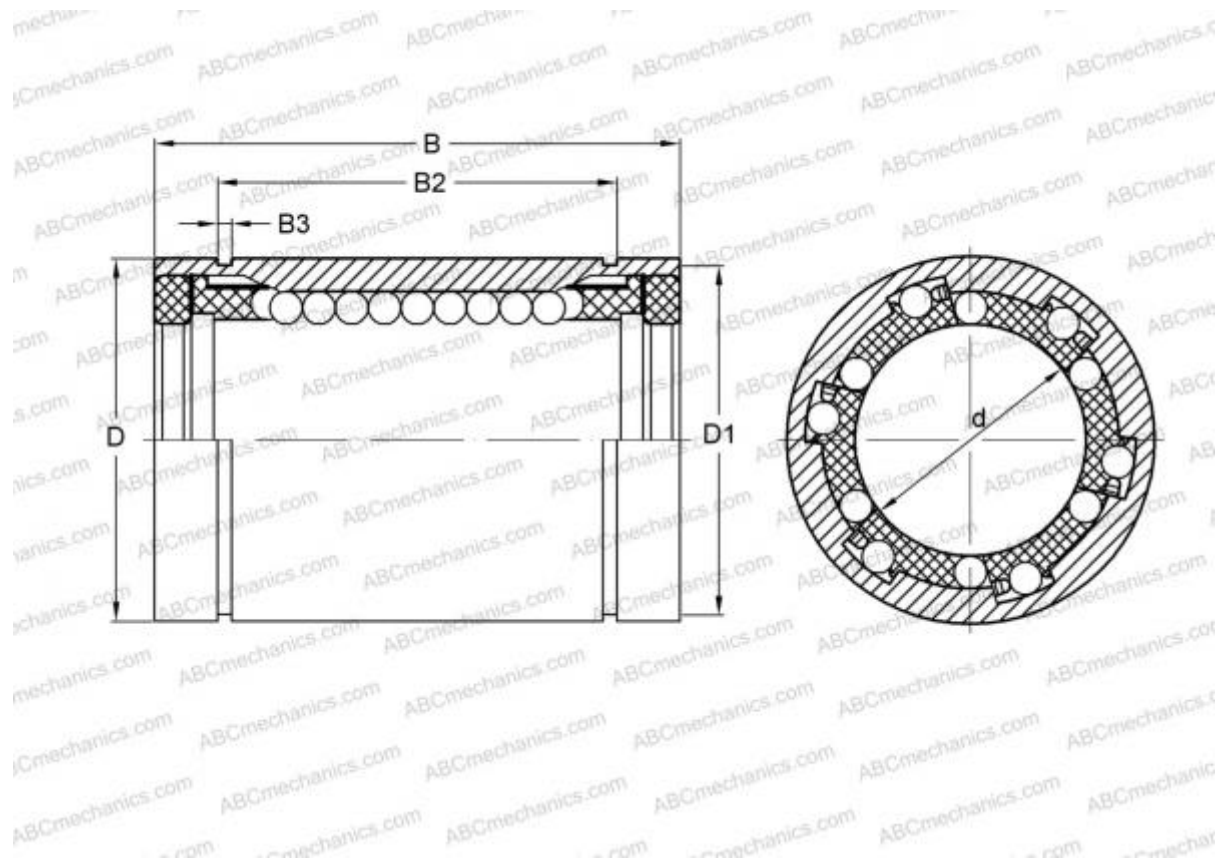

Technical specification

DIMENSIONS, MM

d	30,000
D	47,000
B	68,000

WEIGHT, KG 0,305

MANUFACTURER [IKO](#)

INTERCHANGE

ABC	LBE 30 UU
STAR	0602-030-10
THOMSON	0602-030-10
INA	KB30-PP
SKF	LBCR 30-2LS
FAG	LAA 30x47x68.2RS

CALCULATION DATA

Basic dynamic load rating min	1,560 kN
Basic dynamic load rating max	1,650 kN
Basic static load rating min	3,060 kN
Basic static load rating max	3,910 kN