

LBE 40 UU IKO

Linear bushing

TYPE: Shaft guidance systems, Linear bushing, Standard, Close type, Type LBE..UU, KB..PP, LBCR..2LS, sealed on both sides

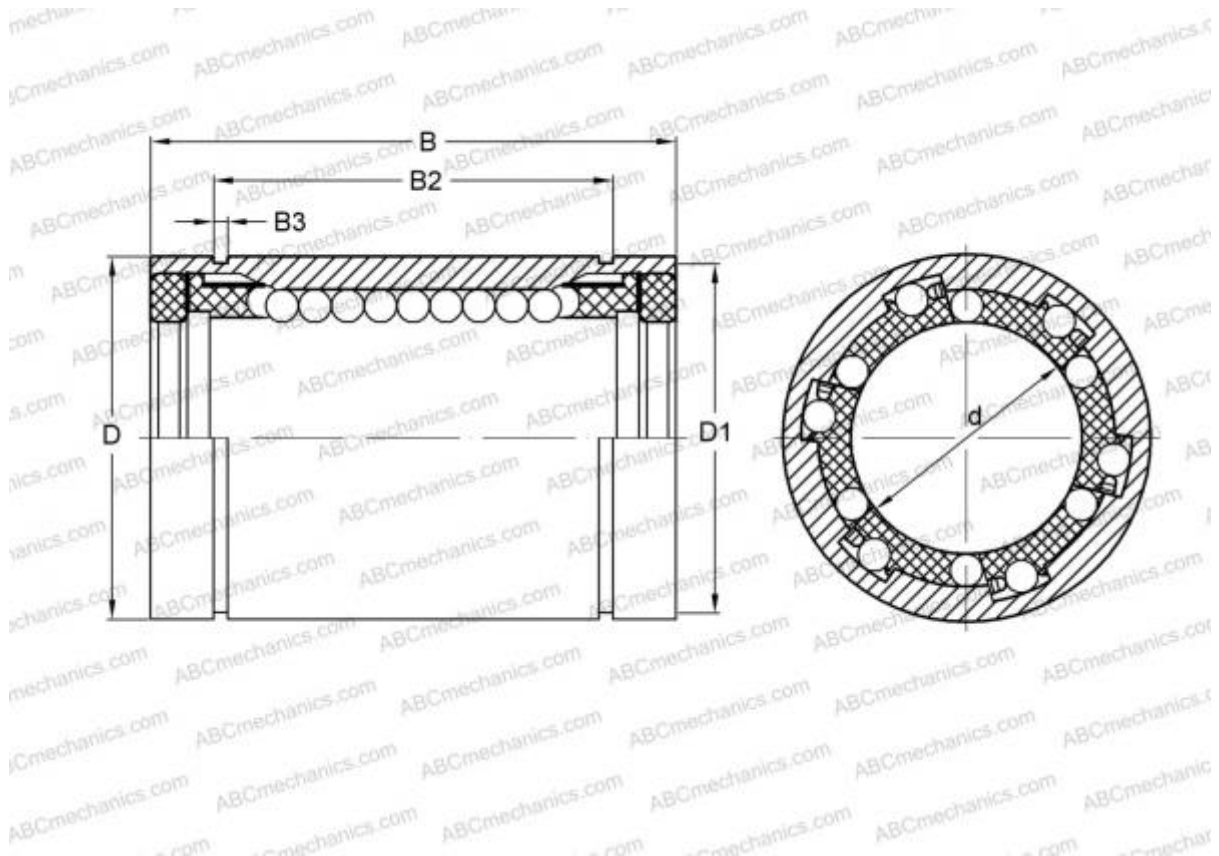

Technical specification

DIMENSIONS, MM

d	40,000
D	62,000
B	80,000

WEIGHT 0,555

MANUFACTURER [IKO](#)

INTERCHANGE

ABC	LBE 40 UU
STAR	0602-040-10
THOMSON	0602-040-10
INA	KB40-PP
SKF	LBCR 40-2LS
FAG	LAA 40x62x80.2RS

CALCULATION DATA

Basic dynamic load rating min	2,710 kN
Basic dynamic load rating max	2,870 kN
Basic static load rating min	4,890 kN
Basic static load rating max	6,250 kN