

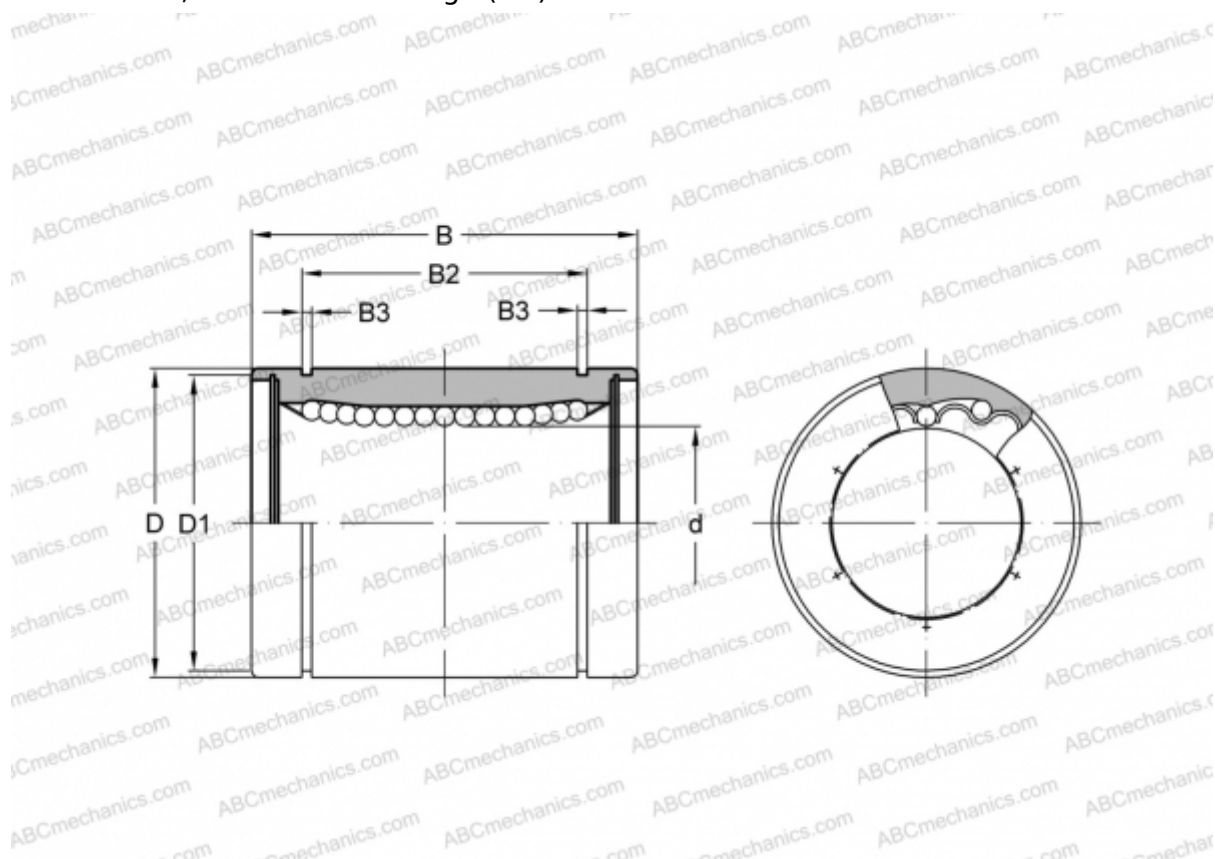

SMS 8s NB

Linear bushing

TYPE: Shaft guidance systems, Linear bushing, Standard, Close type, Type SM, Asian standard, Corrosion resistance, Stainless steel cage (NB)



Technical specification

DIMENSIONS, MM

d	8,000
D	15,000
B	17,000
D1	14,300
B2	11,500
B3	1,100

WEIGHT, KG 0,011

MANUFACTURER [NB](#)

