

## LBE 50 UU AJ IKO

Linear bushing

TYPE: Shaft guidance systems, Linear bushing, Standard, Adjustable type, Type LBE..UU AJ, sealed on both sides

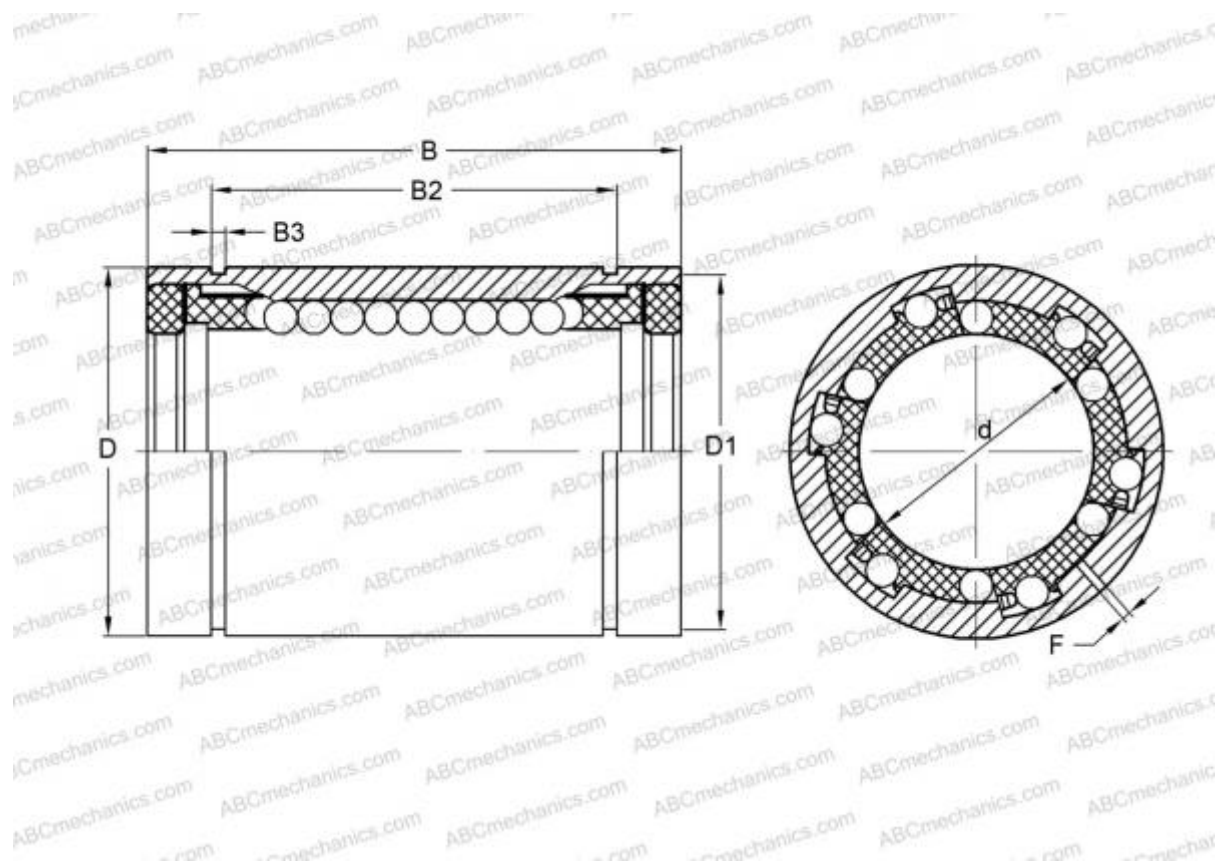

### Technical specification

#### DIMENSIONS, MM

d	50,000
D	75,000
B	100,000
F	2

**WEIGHT, KG** 0,930

**MANUFACTURER** [IKO](#)

#### INTERCHANGE

ABC	<a href="#">LBE 50 UU AJ</a>
STAR	<a href="#">0612-050-10</a>
THOMSON	<a href="#">0612-050-10</a>
INA	<a href="#">KBS50-PP</a>
FAG	<a href="#">LAG 50x75x100.2RS</a>

#### CALCULATION DATA

Basic dynamic load rating min	3,940 kN
Basic dynamic load rating max	4,180 kN
Basic static load rating min	7,130 kN
Basic static load rating max	9,120 kN