

## LBB 12 IKO

Linear bushing

TYPE: Shaft guidance systems, Linear bushing, Standard, Close type, Type LBB, inch

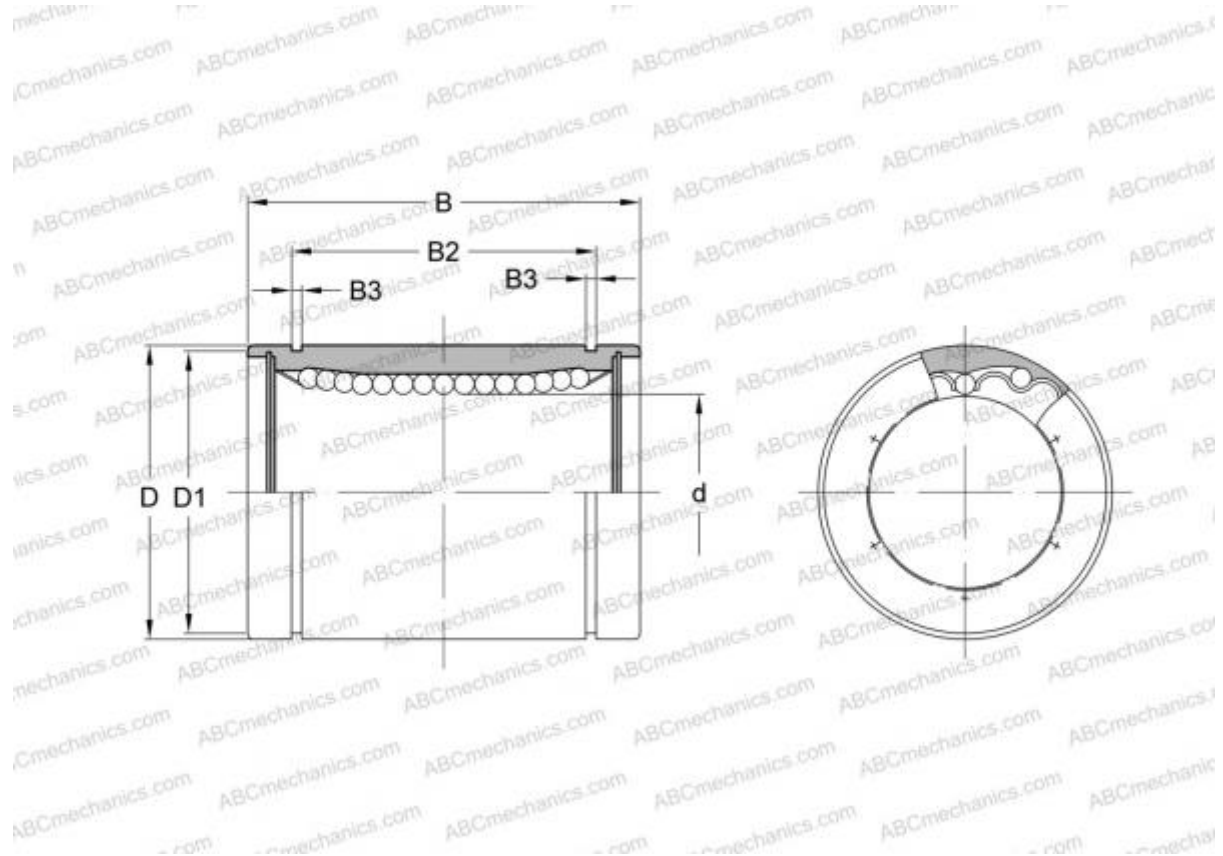

### Technical specification

#### DIMENSIONS, MM

d	19,050
D	31,750
B	41,275

**WEIGHT, KG** 0,080

**MANUFACTURER** [IKO](#)

#### INTERCHANGE

ABC	<a href="#">LBB 12</a>
THOMSON	<a href="#">A-122026</a>
HEIM	<a href="#">LBB-750</a>

#### CALCULATION DATA

Basic static load rating max	1,680 kN
------------------------------	----------

#### CALCULATION DATA

Basic dynamic load rating min	0,608 kN
Basic dynamic load rating max	0,724 kN
Basic static load rating min	1,150 kN