

LBB 24 IKO

Linear bushing

TYPE: Shaft guidance systems, Linear bushing, Standard, Close type, Type LBB, inch

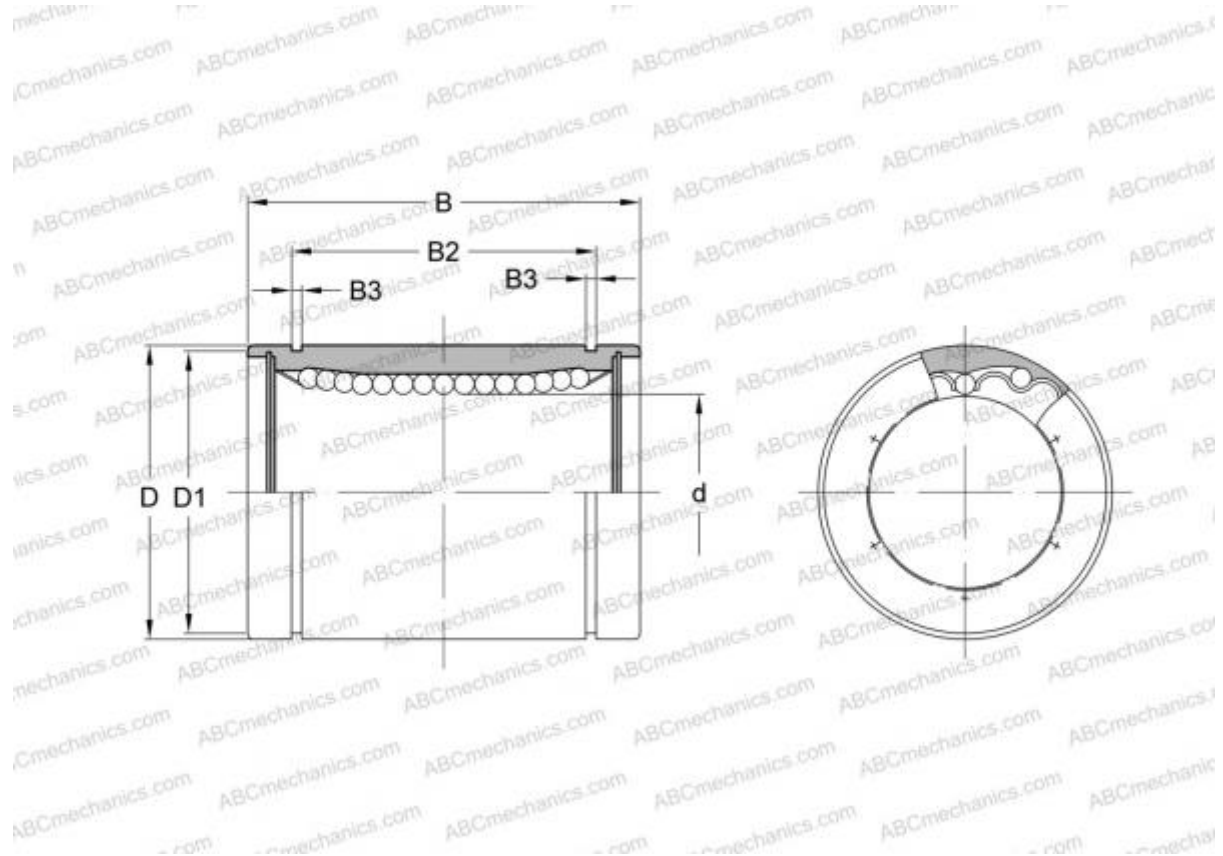

Technical specification

DIMENSIONS, MM

d	38,100
D	60,325
B	76,200

WEIGHT, KG 0,535

MANUFACTURER [IKO](#)

INTERCHANGE

ABC	LBB 24
THOMSON	A-243848
HEIM	LBB-1500

CALCULATION DATA

Basic static load rating max	5,540 kN
------------------------------	----------

CALCULATION DATA

Basic dynamic load rating min	2,460 kN
Basic dynamic load rating max	2,610 kN
Basic static load rating min	4,330 kN