

LBB 10 AJ ABC

Linear bushing

TYPE: Shaft guidance systems, Linear bushing, Standard, Adjustable type, Type LBB..AJ, inch

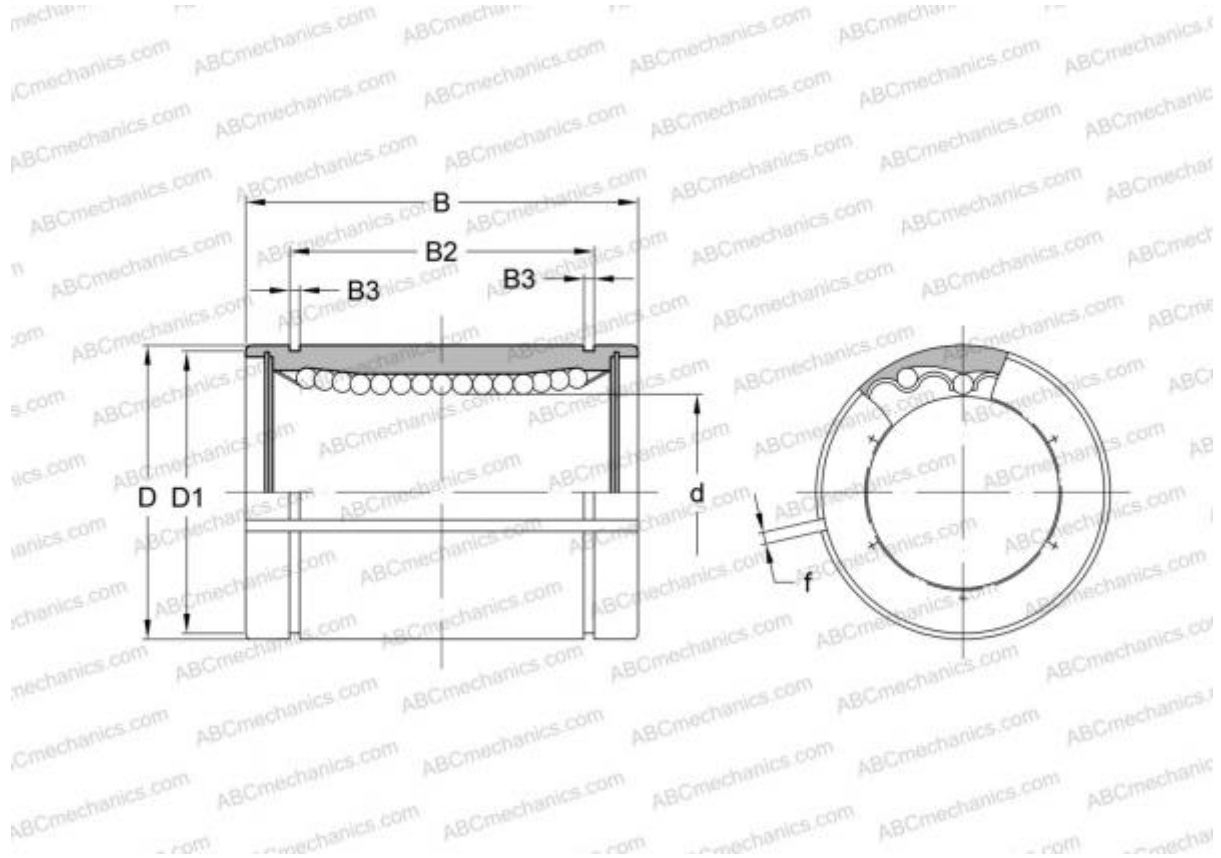

Technical specification

DIMENSIONS, MM

d	15,875
D	28,575
B	38,100
f	2,381

WEIGHT, KG 0,064

MANUFACTURER [ABC](#)

INTERCHANGE

IKO	LBB 10 AJ
THOMSON	ADJ-101824
HEIM	ADJ-625