

ADJ-101824 THOMSON

Linear bushing

TYPE: Shaft guidance systems, Linear bushing, Standard, Adjustable type, Type LBB..AJ, inch

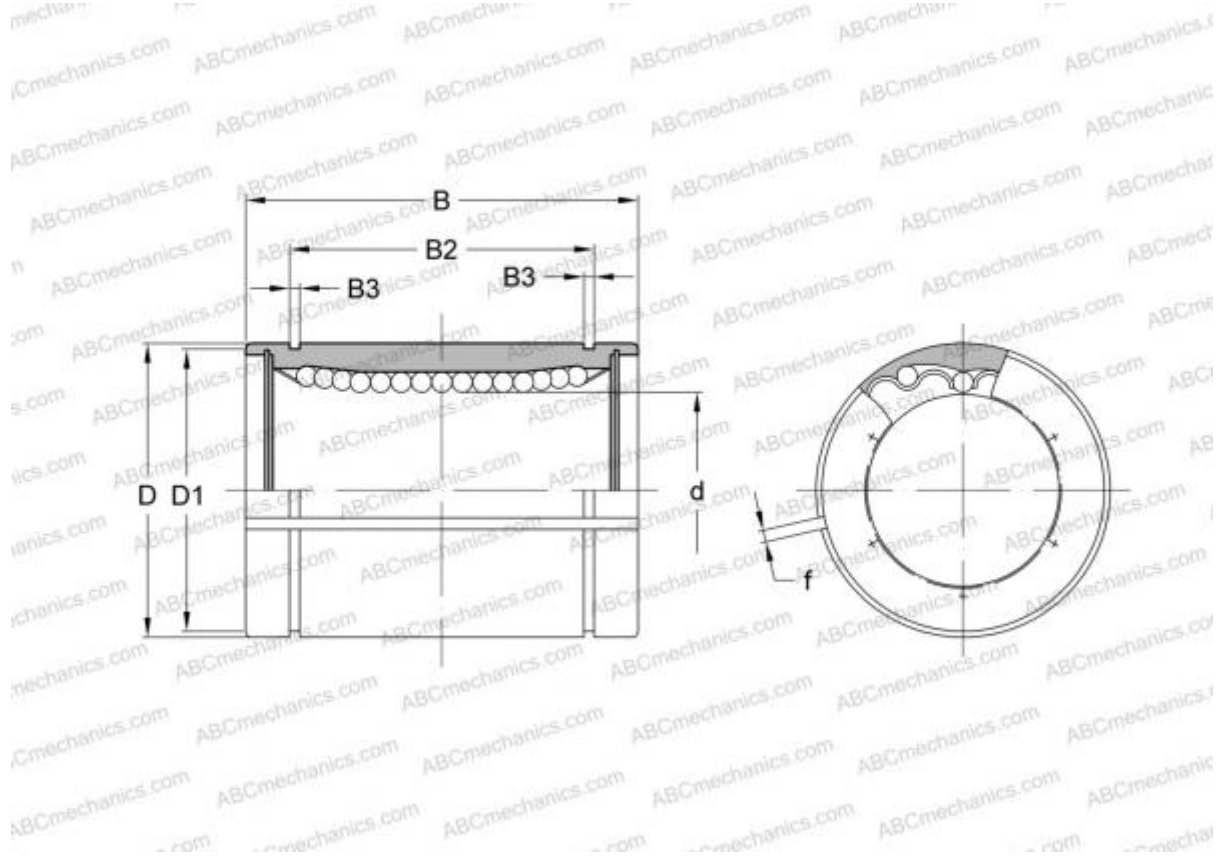

Technical specification

DIMENSIONS, MM

d	15,875
D	28,575
B	38,100
f	2,381

WEIGHT, KG 0,064

MANUFACTURER [THOMSON](#)

INTERCHANGE

ABC	LBB 10 AJ
IKO	LBB 10 AJ
HEIM	ADJ-625