

LBB 12 AJ IKO

Linear bushing

TYPE: Shaft guidance systems, Linear bushing, Standard, Adjustable type, Type LBB..AJ, inch

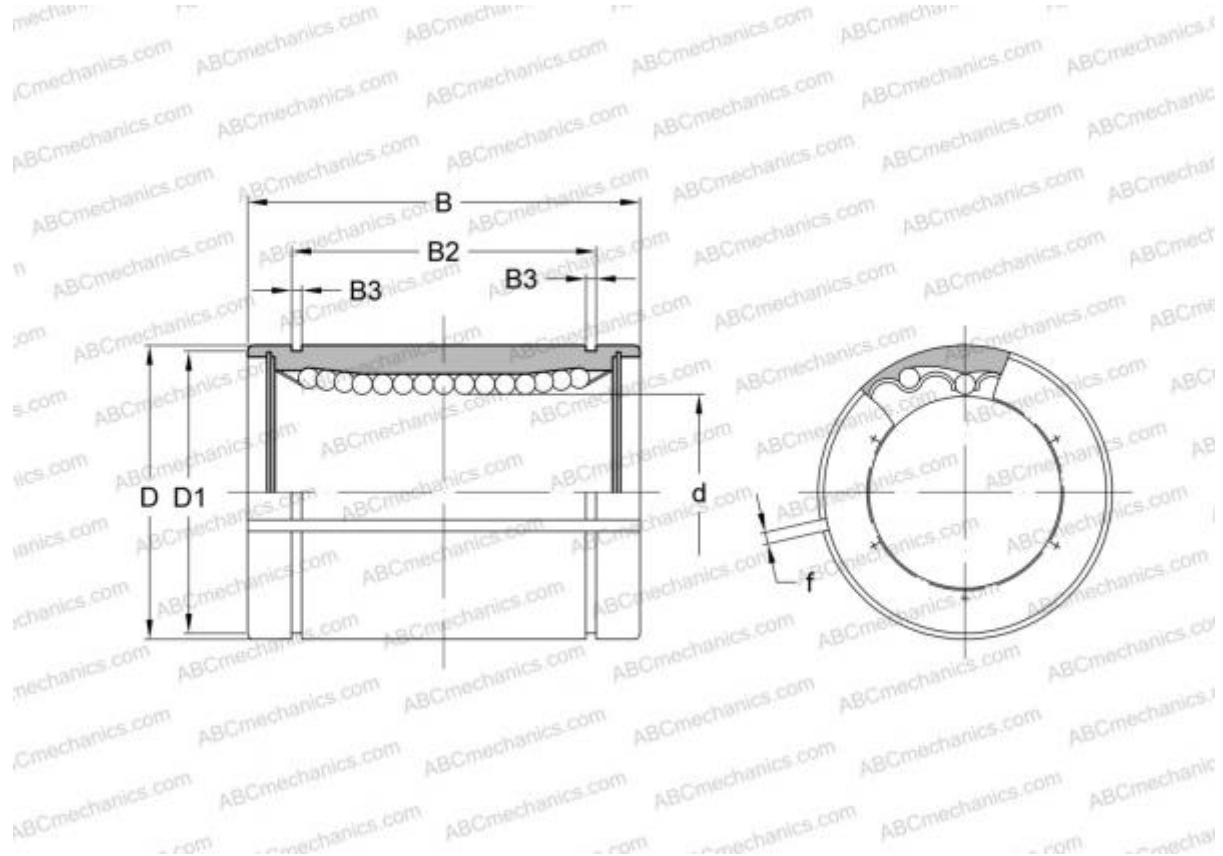

Technical specification

DIMENSIONS, MM

d	19,050
D	31,750
B	41,275
f	2,381

WEIGHT, KG 0,079

MANUFACTURER [IKO](#)

INTERCHANGE

ABC	LBB 12 AJ
THOMSON	ADJ-122026
HEIM	ADJ-750

CALCULATION DATA

Basic dynamic load rating min	0,608 kN
Basic dynamic load rating max	0,724 kN

CALCULATION DATA

Basic static load rating min	1,150 kN
Basic static load rating max	1,680 kN