

LBB 4 UU IKO

Linear bushing

TYPE: Shaft guidance systems, Linear bushing, Standard, Close type, Type LBB..UU, sealed on both sides, inch

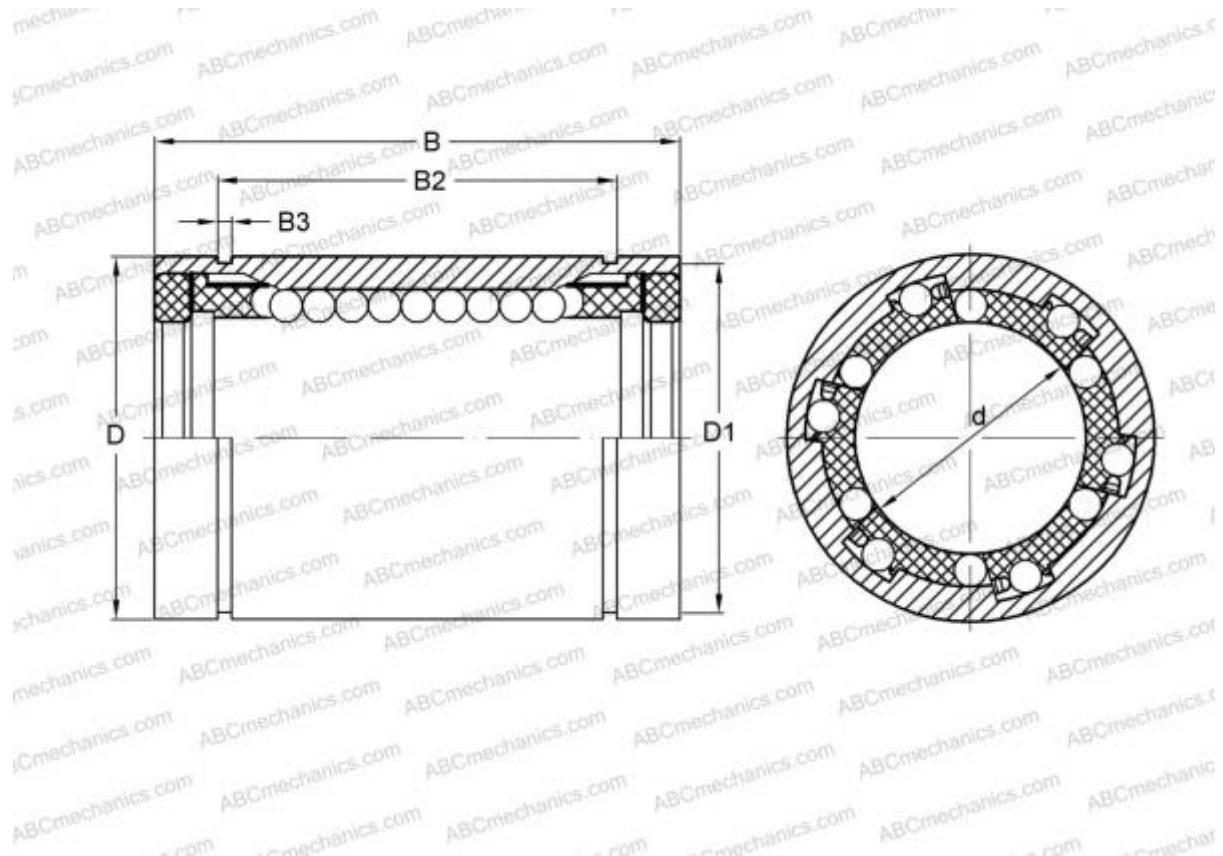

Technical specification

DIMENSIONS, MM

d	6,350
D	12,700
B	19,050

WEIGHT 0,007

MANUFACTURER [IKO](#)

INTERCHANGE

ABC	LBB 4 UU
HEIM	LBB-250 PP

CALCULATION DATA

Basic dynamic load rating min	0,080 kN
Basic dynamic load rating max	0,065 kN
Basic static load rating min	0,156 kN
Basic static load rating max	0,156 kN