

## LBB 6 UU IKO

Linear bushing

TYPE: Shaft guidance systems, Linear bushing, Standard, Close type, Type LBB..UU, sealed on both sides, inch

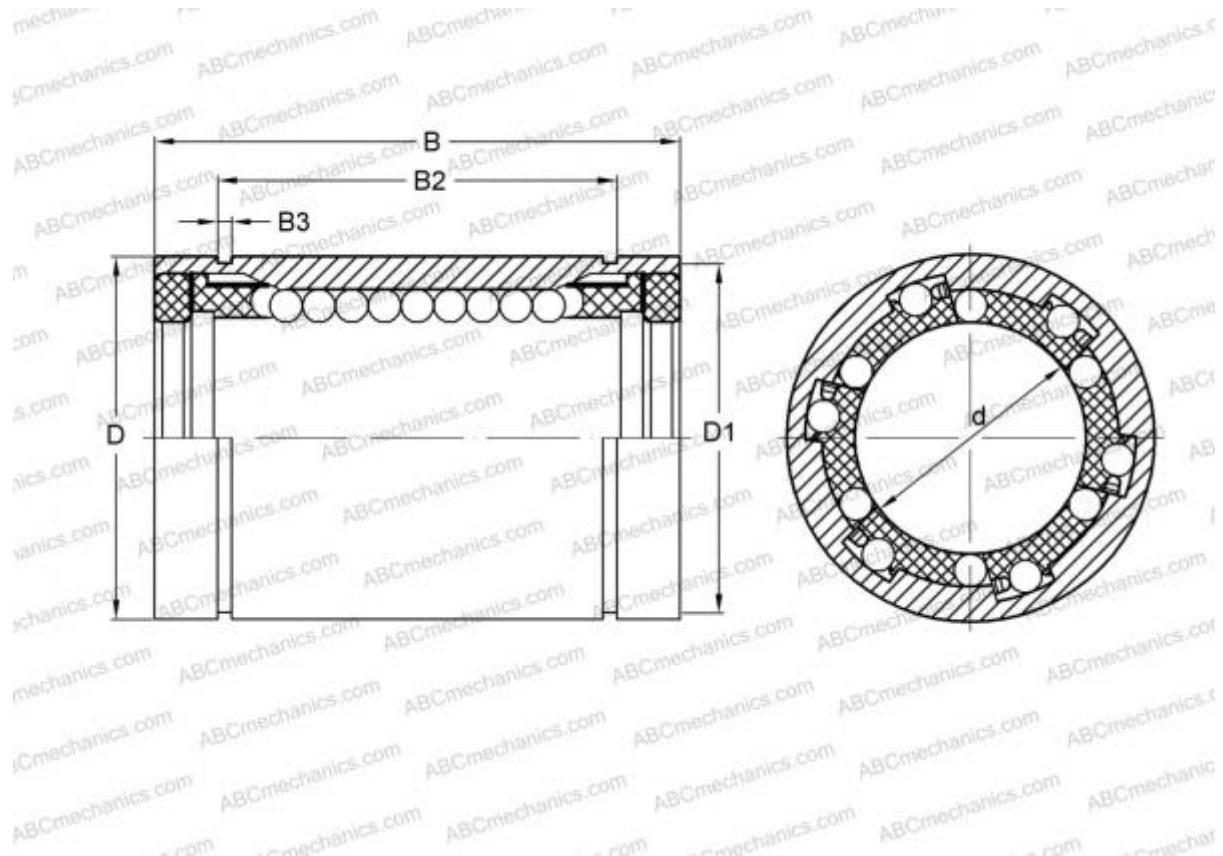

### Technical specification

#### DIMENSIONS, MM

d	9,525
D	15,875
B	22,225

**WEIGHT** 0,010

**MANUFACTURER** [IKO](#)

#### INTERCHANGE

ABC	<a href="#">LBB 6 UU</a>
HEIM	<a href="#">LBB-375 PP</a>

#### CALCULATION DATA

Basic dynamic load rating min	0,117 kN
Basic dynamic load rating max	0,134 kN
Basic static load rating min	0,227 kN
Basic static load rating max	0,320 kN