

## LBB 10 UU IKO

Linear bushing

TYPE: Shaft guidance systems, Linear bushing, Standard, Close type, Type LBB..UU, sealed on both sides, inch

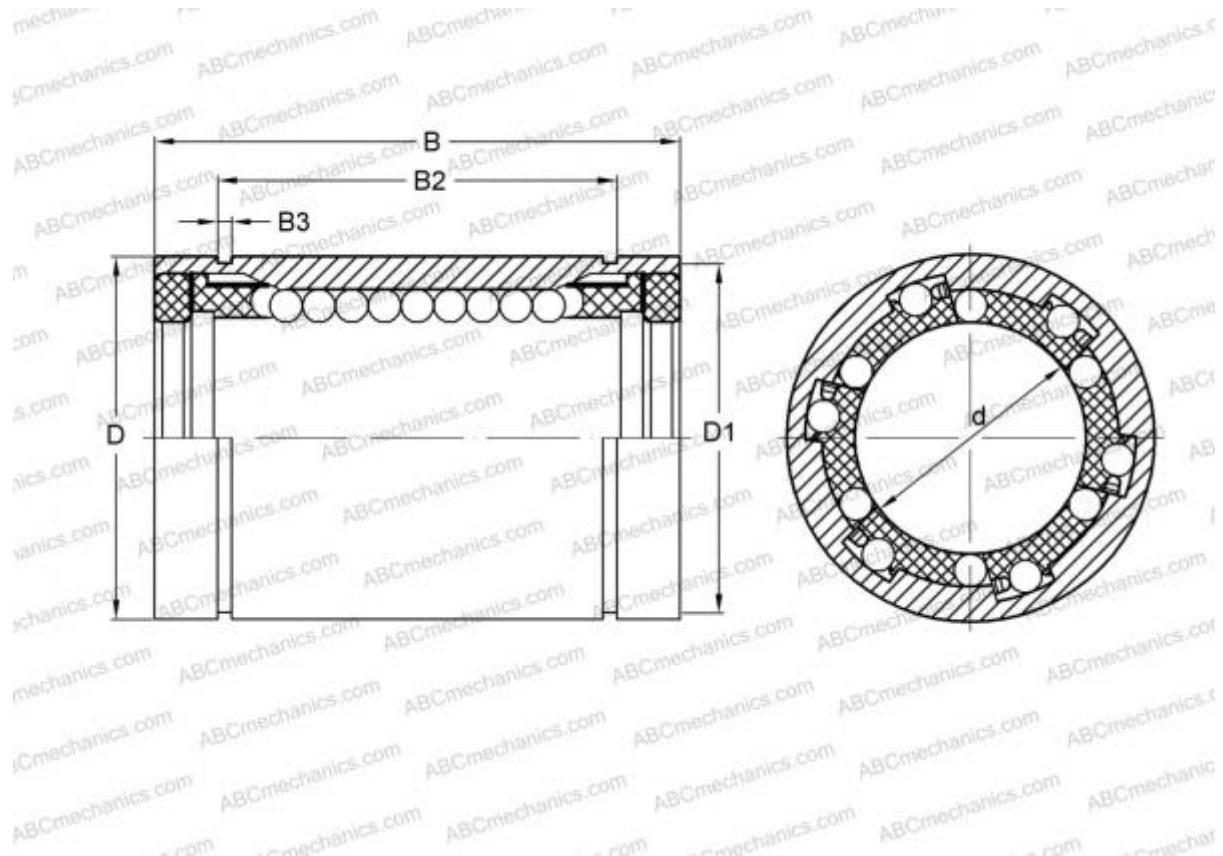

### Technical specification

#### DIMENSIONS, MM

d	15,875
D	28,575
B	38,100

**WEIGHT, KG** 0,065

**MANUFACTURER** [IKO](#)

#### INTERCHANGE

ABC	<a href="#">LBB 10 UU</a>
HEIM	<a href="#">LBB-625 PP</a>

#### CALCULATION DATA

Basic dynamic load rating min	0,424 kN
Basic dynamic load rating max	0,488 kN
Basic static load rating min	0,766 kN
Basic static load rating max	1,080 kN